

FREEMAN MARINE Quick-Acting doors feature patented chain-drive, single actuation dogging. This design feature allows for quick-acting doors with unique shapes, camber, knuckles and sloping surfaces. Premium Duty, Quick-Acting doors are designed for transom access and other locations where watertight integrity is critical. A single piece neoprene or silicone gasket on the door panel's perimeter presses against a knife-edged jamb for a high compression, uniformly tight seal. Standard commercial and machinery space doors often feature FREEMAN'S trademark lineal brushed finish that creates a durable, uniform texture. When specified with optional yacht-quality paint to your color specification, welded construction results in a smooth, seamless exterior that features long lasting beauty. Doors offer welded-in windows and can accommodate special glazing. 1430 Series Quick-Acting Premium Duty doors are specified where aggressive sealing is required:

- Transom • Bulkheads • Below Deck Compartments
- Engine Room • Main Deck



\*\* Degree of watertightness depends on number of dogs, proper installation and sealing adjustment. Watertight doors are individually defined, specified and fabricated for each application.

**QUICK-ACTING, PREMIUM DUTY DESIGN FEATURES**

- **Designed For Watertight Rated Locations\*\***
- **Patented Chain Drive Quick-Acting Dogging**
- **Custom Sizing, width and height**
- **.160"~.250" Thick Aluminum Panel Skins**
- **Welded Frame and Skin Construction**
- **Gasket on Door Panel for Long Life and Positive Sealing**
- **Radius or Mitered Corners**
- **Bolt-in, Weld-in or Clamp-in Frames**
- **Added Internal Stiffeners**
- **Lineal Sanded Finish Yacht-quality painted finish (avail)**
- **Single Actuation Handles (wide selection avail)**
- **Glass Filled Striker Wedges**
- **Solid Insulation (opt materials avail)**
- **Surface and Concealed Hinges (avail)**
- **Stainless Steel Fasteners**
- **Welded In Window, glazing and tint (opt avail)**



When watertight sealing is required, door styles with a knife-edge coaming, large gasket surface and floating hinges should be specified. A wide selection of coaming profiles, hinges styles as well as both neoprene and silicone gaskets are available.

Right;  
Transom door,  
Yoke hinge



Chain-drive, Stiffeners,  
Interior panel with inspection  
plate at left in photo



Above, Single Pantograph hinge, Open  
Right Inset, Single Pantograph hinge, Closed



Transom door, Closed



12" view port,  
Eight dogs



12" view port,  
Blade hinges



Watertight door,  
Welded surface hinges,  
7" view port,  
Closed, Front view



Aluminum shallow  
Gutter coaming,  
Hold open with gas spring,  
7" view port,  
Closed, Inside view



Dome handle,  
Euro hinges,  
7" view port,  
Closed, Front view



Stainless steel wheel, 12" view port, Closed;  
Left, Front view; Right, Inside view





No window, Euro hinges,  
Bare aluminum coaming  
for weld-in



No window, Blade hinges,  
Escape door



Gullwing,  
Top edge knuckle,  
Dome handle,  
Prep for builder facade



Knuckle,  
Pantograph  
Hinge,  
Proud coaming



Euro hinges,  
Handle lever  
double bow,  
Painted



No window,  
Dome handle  
12", Coaming  
with custom  
panel for soft  
patch



Pantograph hinge  
Dome handle 17",  
Hull profiled,  
Transom door



Raked door,  
Lever flat low  
profile, Builder  
applied fascia  
to be installed



Upper half window,  
Lever handle,  
Painted



Pantograph hinges,  
Hull profile, Knuckle,  
Wheel handle



Yoke hinge, Dome handle,  
Chain deadbolt lock



No window, Yoke hinges,  
Flat bar steel coaming with  
flange over yoke hinges



Pantograph hinges,  
Dome handle 17",  
Custom profile



Yoke hinges, Bi-square opening, Closed



Yoke hinges, Gas spring with hold open, Closed



Single pantograph hinge,



Yoke hinge, Top edge knuckle, Open



Single pantograph hinge, Closed

Hinge, Flush, Floating pin for watertight doors, Perimeter flange on knife-edge coaming



Hinge, Universal Yoke, With stop bumper



Hinge, Vibratory finish



Gullwing knuckle, Forepeak access door



Gullwing transom door, Leading to crews quarters



Gullwing transom door in production fixture

Sill, Removable



Striker for sensor installation to indicate closed position



Chain drive dogging and striker

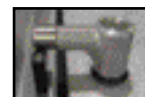

Handle, Lever double bow, Polished



Lockset on watertight door



Handle, Lever - return and finger grips, Chain dead bolt thumb turn

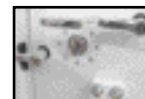

Handle, Lever - return and finger grips, With lock and roller bearing, Polished



Open, outside, Flush weld-on



Yoke hinge, Open



Large window, Hold open, Stainless steel flat bar coaming, Open

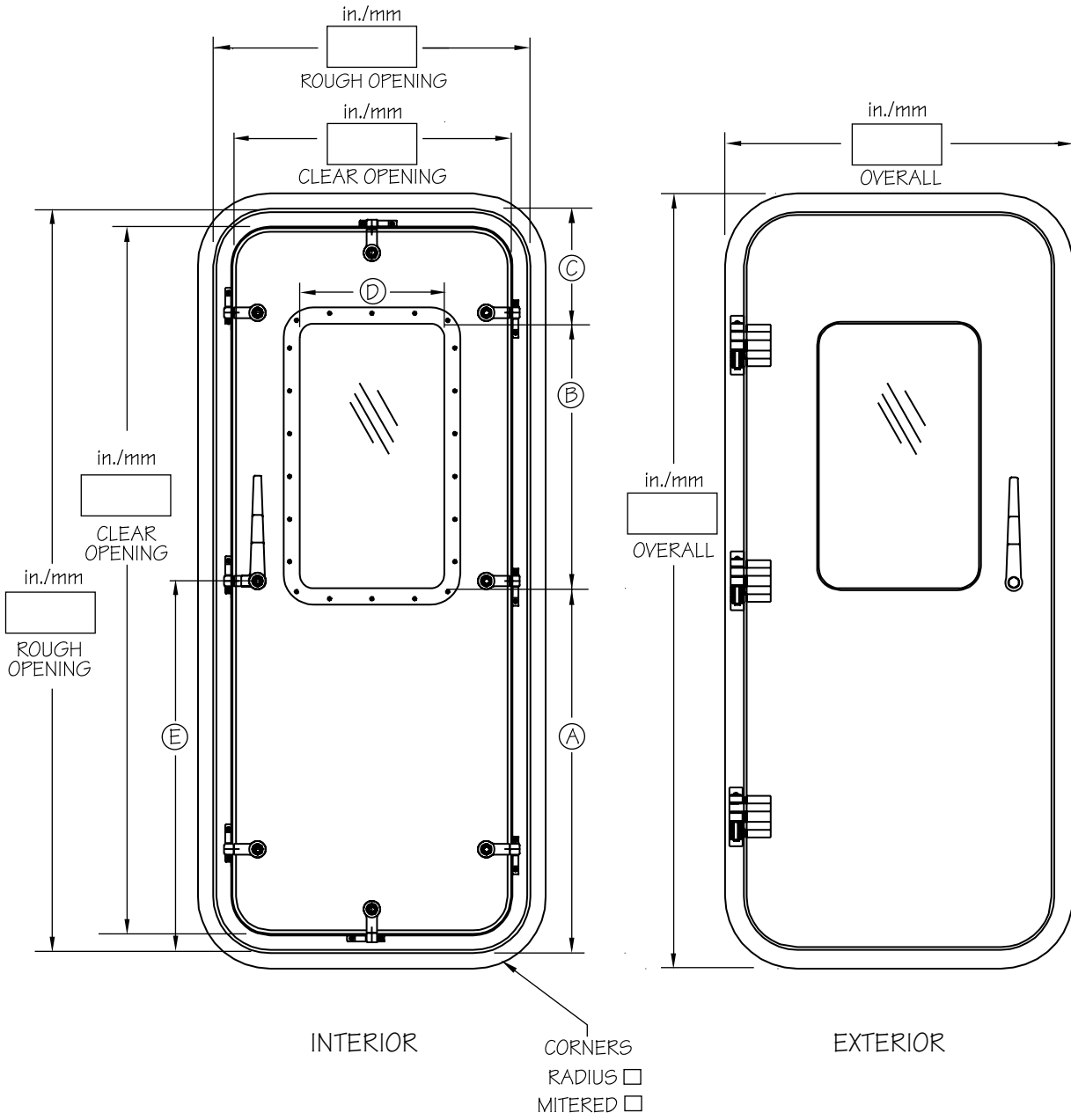

inches		mm		Dimensions For options
A				Bottom of Clear Glass to Bottom Rough Opening
B				Clear Glass Height
C				Top of Clear Glass to Top of Rough Opening, min 7"
D				Clear Glass Width, min side clearance 6"
E				Handle/Lockset - C/L to Bottom Rough Opening
F	Locate on drawing			Quick-Acting Handle - Outside & Inside

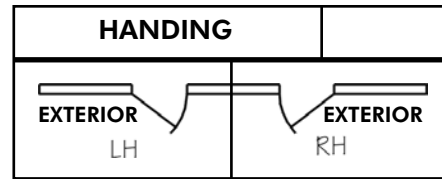

<b>Scale</b>	None
--------------	------

© ALL RIGHTS RESERVED  
2010 FREEMAN MARINE EQUIPMENT, INC.  
SPECIFICATIONS SUBJECT TO CHANGE WITHOUT NOTICE

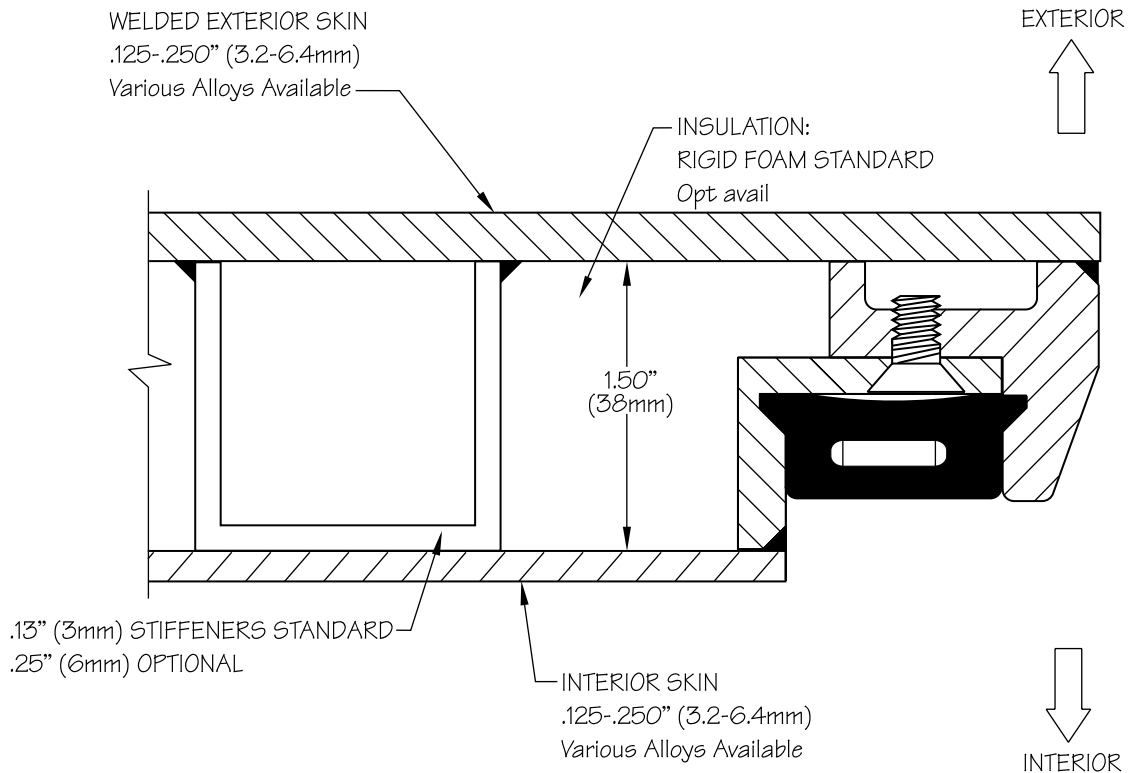
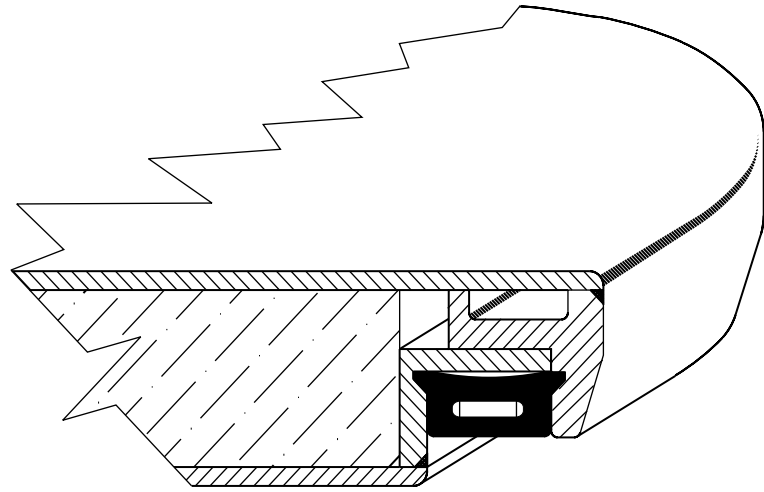

**PANEL**

<b>Sealing Performance</b>	Watertight		
<b>Availability</b>	1130 Single	1430 Quick-Acting	1530 Dutch
Degree of watertightness depends on panel and coaming construction, number of dogs, proper installation and sealing adjustment. Closures are individually defined, specified and fabricated for each application.			

© ALL RIGHTS RESERVED  
2010 FREEMAN MARINE EQUIPMENT, INC.  
SPECIFICATIONS SUBJECT TO CHANGE WITHOUT NOTICE

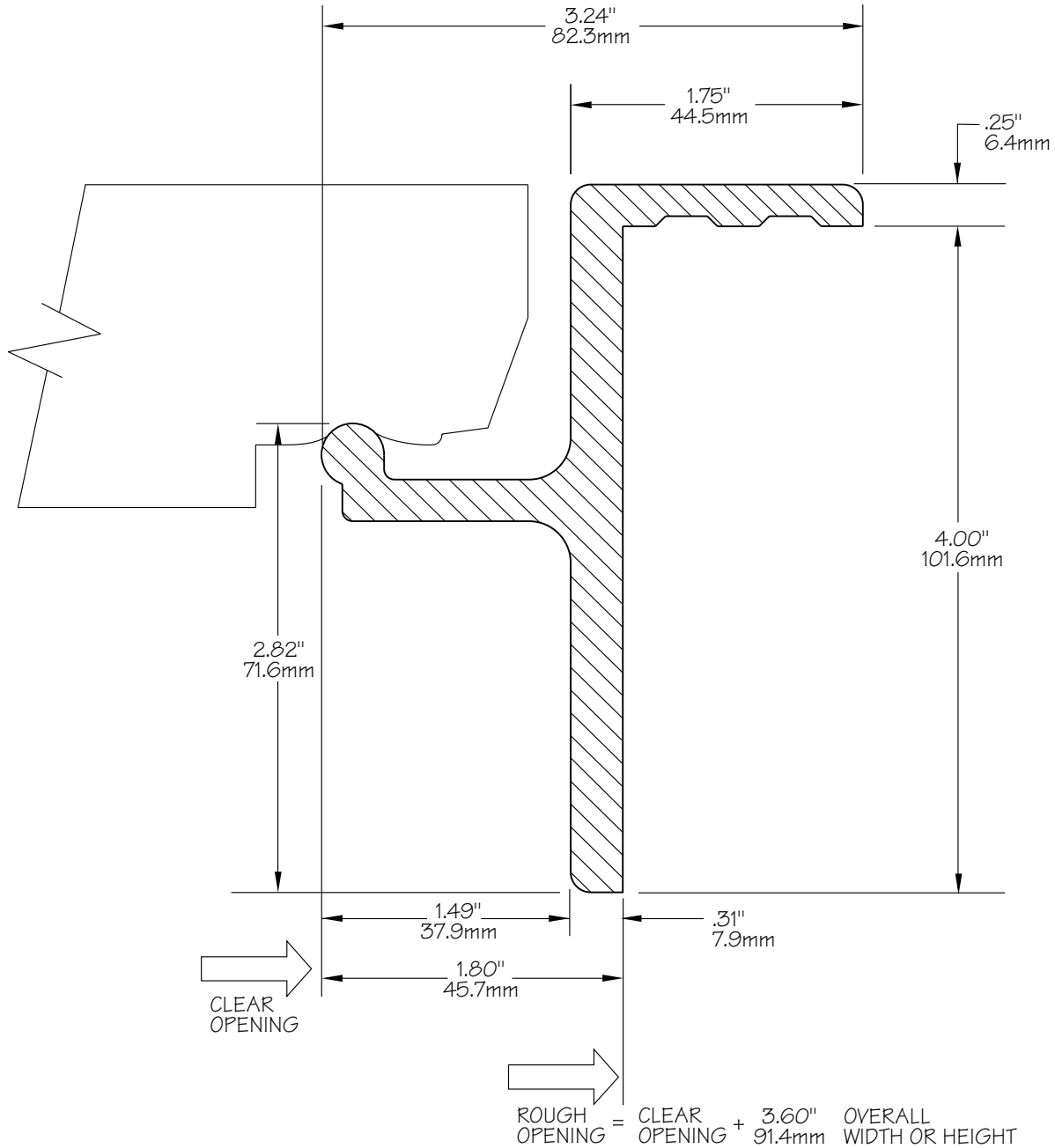

**0641-1016**

<b>Coaming Assembly No.</b>	<b>0641-1016</b>	Degree of watertightness depends on panel and coaming construction, number of dogs, proper installation and sealing adjustment. Closures are individually defined, specified and fabricated for each application.
<b>Gasket Seal Stop Type</b>	Knife-edge	
<b>Coaming Material</b>	Aluminum	
<b>Coaming Configuration</b>	Extrusion w/ Shallow Gutter	
<b>Stop Type</b>	Fixed	
		© ALL RIGHTS RESERVED 2010 FREEMAN MARINE EQUIPMENT, INC. SPECIFICATIONS SUBJECT TO CHANGE WITHOUT NOTICE

**COAMING**

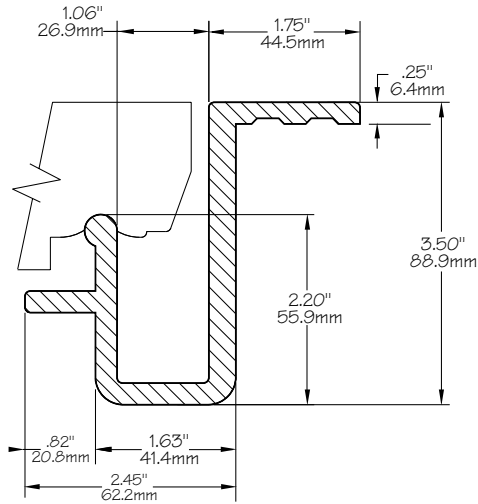

Aluminum - Custom Extrusion  
3.50" X 1.75", w/ Flange  
Deep Gutter - Fixed Knife-Edge  
**0641-1014**

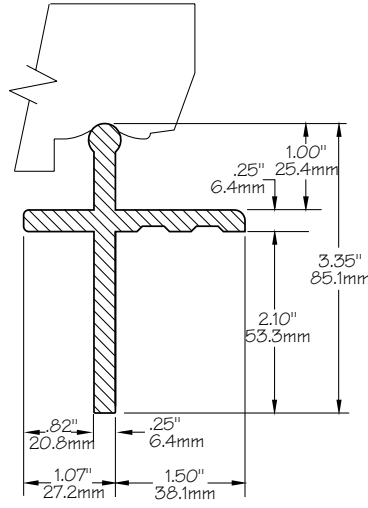

Aluminum - Extrusion Bulkhead Proud  
Fixed Knife-Edge  
**0641-1015**

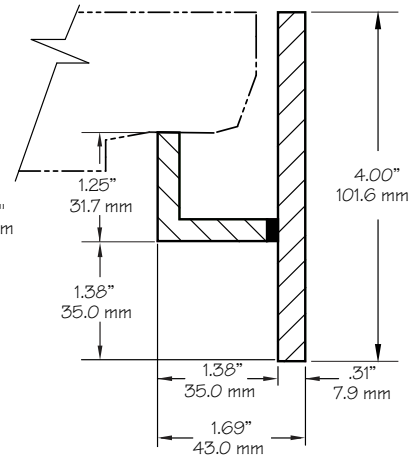

Steel - .31" Flat Bar w/ Weld-on Gutter  
Fixed Knife-Edge  
**0641-1049**

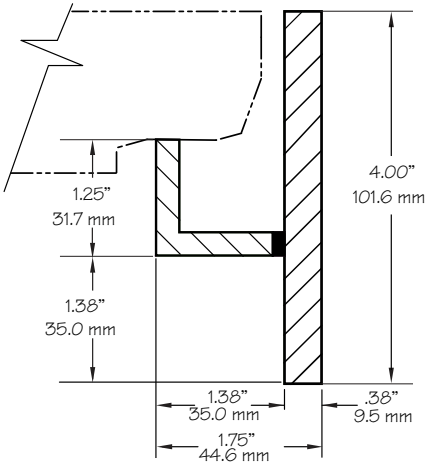

Steel - .38" Flat Bar w/ Weld-on Gutter  
Fixed Knife-Edge  
**0641-1039**

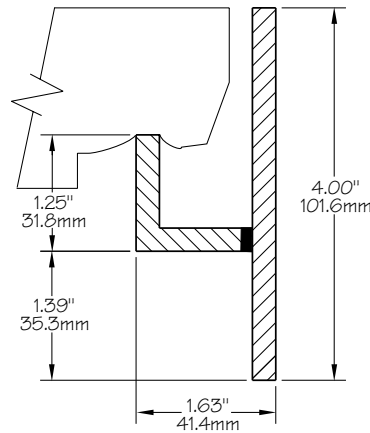

Stainless Steel - Angle/Channel  
Gutter - Fixed Knife-Edge  
**0641-1025**

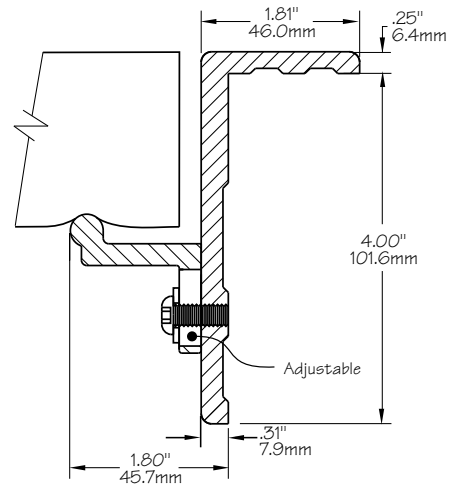

Aluminum - Angle Extrusion, 4.25" X 1.81", w/ Flange  
Stop - Adjustable, Knife-Edge  
**0641-1017**

**COAMING**

Degree of watertightness depends on panel and coaming construction, number of dogs, proper installation and sealing adjustment. Closures are individually defined, specified and fabricated for each application.

© ALL RIGHTS RESERVED  
2010 FREEMAN MARINE EQUIPMENT, INC.  
SPECIFICATIONS SUBJECT TO CHANGE WITHOUT NOTICE



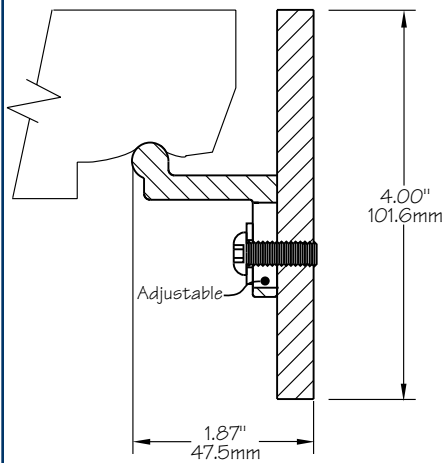

Aluminum - Flat Bar, 4.0" X .38", No Flange  
Stop - Adjustable, Knife-Edge  
**0641-1018**

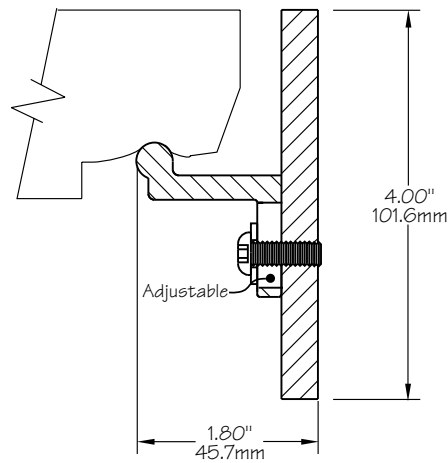

Steel - Flat Bar, 4.0" X .32", No Flange  
Stop - Adjustable, Knife-Edge  
**0641-1035**

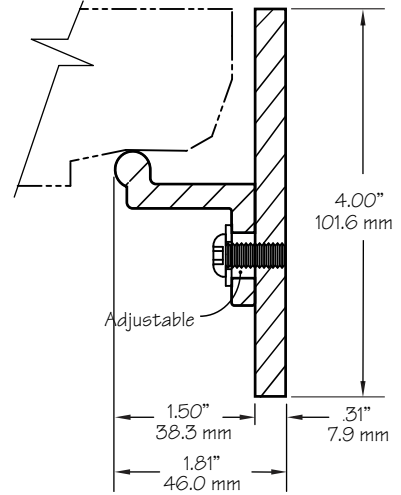

Steel - Flat Bar, 4.0" x .38", No Flange  
Stop - Adjustable, Knife-Edge  
**0641-1040**

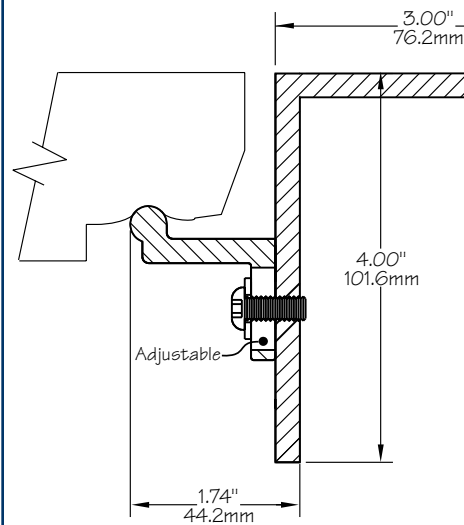

Steel - Angle, 4.0" x 3" x .25", w/ Flange  
Stop - Adjustable, Knife-Edge  
**0641-1036**

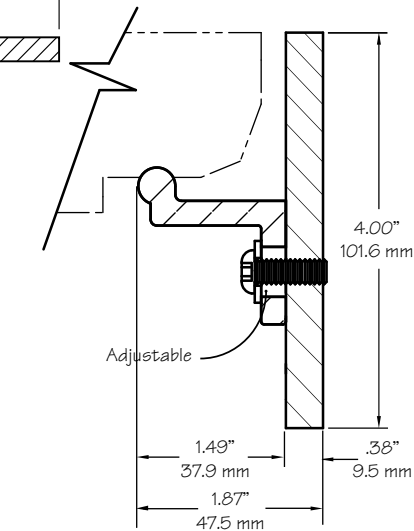

Stainless Steel - Flat Bar, .38", No Flange  
Stop - Adjustable, Knife-Edge  
**0641-1042**

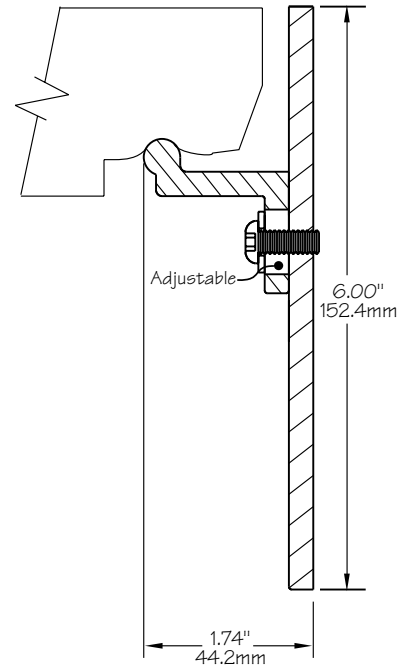

Stainless Steel - Flat Bar 6.0" X .25", No Flange  
Stop - Adjustable, Knife-Edge  
**0641-1027**

Degree of watertightness depends on panel and coaming construction, number of dogs, proper installation and sealing adjustment. Closures are individually defined, specified and fabricated for each application.

© ALL RIGHTS RESERVED  
2010 FREEMAN MARINE EQUIPMENT, INC.  
SPECIFICATIONS SUBJECT TO CHANGE WITHOUT NOTICE

**COAMING**



**Available on Door:** 1420  
1430  
1432  
1520  
1620

**Location:** Outside

**Finish:** Polished

**Handle Material:** Stainless Steel

**Feature:** Locate Anywhere

**BI-SQUARE**

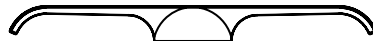
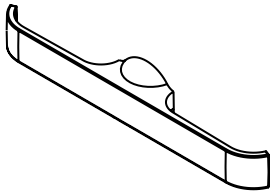

**Available on Door:** 1420  
1430  
1432

**Location:** Outside  
Inside

**Finish:** Painted  
Polished  
Vibratory

**Handle Material:** Aluminum

**Feature:** Centrally Located

**LEVER WITH FLAT, DOUBLE BOW**

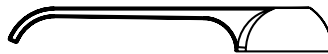
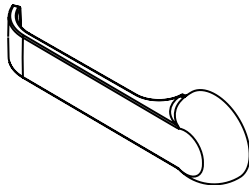

**Available on Door:** 1420  
1430  
1432  
1520  
1530

**Location:** Outside  
Inside

**Finish:** Painted  
Polished  
Vibratory

**Handle Material:** Aluminum

**Feature:** Locate Anywhere

**LEVER WITH FLAT, LOW PROFILE**

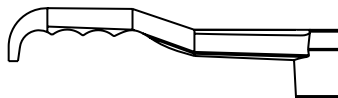
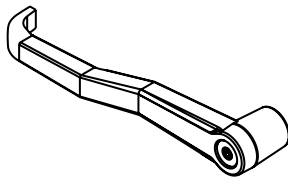

**Available on Door:** 1420  
1430  
1432  
1520  
1530

**Location:** Outside  
Inside

**Finish:** Painted  
Polished  
Vibratory

**Handle Material:** Aluminum

**Feature:**

**LEVER WITH RETURN & FINGER GRIPS**

**Scale** None

© ALL RIGHTS RESERVED  
2010 FREEMAN MARINE EQUIPMENT, INC.  
SPECIFICATIONS SUBJECT TO CHANGE WITHOUT NOTICE

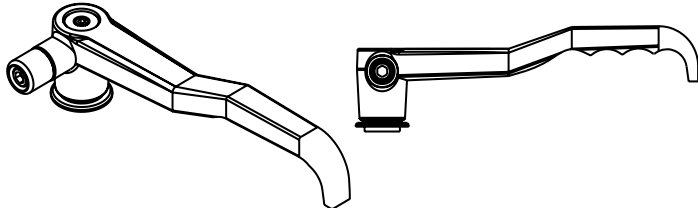

**LEVER WITH RETURN & FINGER GRIPS**

*roller bearing*

**Available on Door:** 1420  
1430  
1432  
1520  
1620

**Location:** Outside  
Inside

**Finish:** Painted  
Polished  
Vibratory

**Handle Material:** Aluminum

**Feature:**

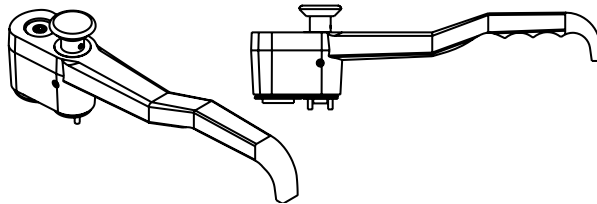

**LEVER WITH RETURN & FINGER GRIPS**

*lock*

**Available on Door:** 1420  
1430  
1432  
1520  
1620

**Location:** Inside

**Finish:** Painted  
Polished  
Vibratory

**Handle Material:** Aluminum

**Feature:**

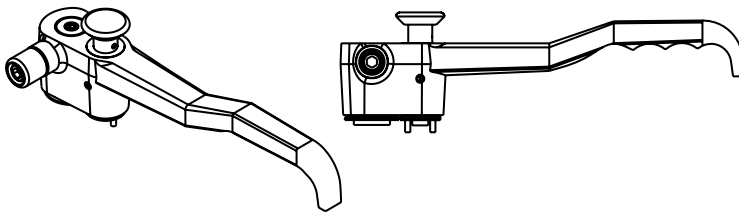

**LEVER WITH RETURN & FINGER GRIPS**

*lock and roller bearings*

**Available on Door:** 1420  
1430  
1520  
1620

**Location:** Inside

**Finish:** Painted  
Polished  
Vibratory

**Handle Material:** Aluminum

**Feature:**

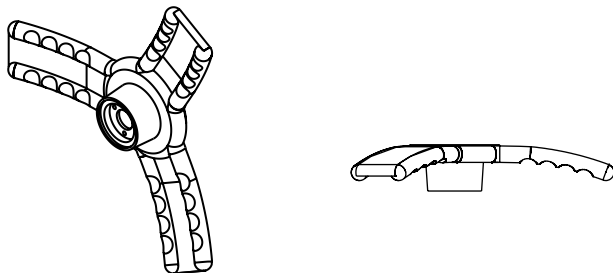

**TRISTAR**

**Available on Door:** 1420  
1430  
1432  
1520  
1620

**Location:** Outside  
Inside

**Finish:** Painted  
Polished  
Vibratory

**Handle Material:** Aluminum

**Feature:** Centrally Located

**Scale** None

© ALL RIGHTS RESERVED  
2010 FREEMAN MARINE EQUIPMENT, INC.  
SPECIFICATIONS SUBJECT TO CHANGE WITHOUT NOTICE

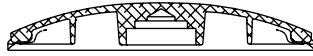

**Available on Door:** 1420  
1430  
1432  
1520  
1620

**Location:** Outside

**Finish:** Painted  
Vibratory

**Handle Material:** Aluminum

**Feature:** Centrally Located

**SEMI-FLUSH DOME 12" DIA.**

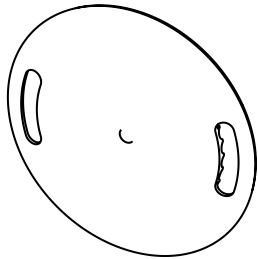

**Available on Door:** 1420  
1430  
1432  
1520  
1620

**Location:** Outside

**Finish:** Painted  
Vibratory

**Handle Material:** Aluminum

**Feature:** Centrally Located

**SEMI-FLUSH DOME 17" DIA.**

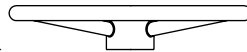
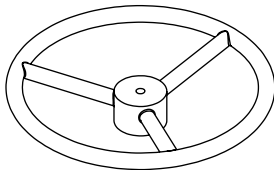

**Available on Door:** 1420  
1430  
1432  
1520  
1620

**Location:** Outside  
Inside

**Finish:** Polished

**Handle Material:** Stainless Steel

**Feature:** Centrally Located

**WHEEL, ROUND 15.25" DIA.**  
*highly polished*

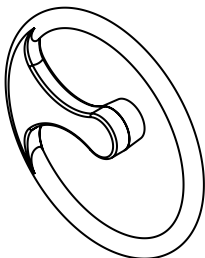

**Available on Door:** 1420  
1430  
1432  
1520  
1620

**Location:** Outside

**Finish:** Painted  
Vibratory

**Handle Material:** Aluminum

**Feature:** Centrally Located

**WHEEL, ROUND 12" DIA.**  
*bolt-on to bi-square*

**Scale** None

© ALL RIGHTS RESERVED  
2010 FREEMAN MARINE EQUIPMENT, INC.  
SPECIFICATIONS SUBJECT TO CHANGE WITHOUT NOTICE

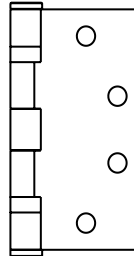
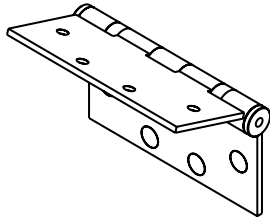

**BUTT HINGE**  
adjustable stop coamings  
4.5" x 4.5", 6.0" x 4.5", 8.0" x 6.0"

**Available on Door:** 1110  
1120  
1420  
1510  
1520  
1610  
1620

**Finishes Available:** Polished  
Satin

**Material:** Stainless Steel

**Attachment:** Bolt-on

(1X10 series requires butt hinge)

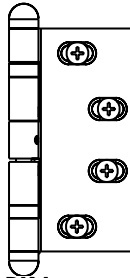
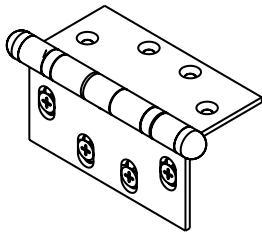

**BUTT HINGE, WITH DOME PIN**  
fixed or adjustable stop coamings  
4.5" x 4.5"

**Available on Door:** 1120  
1420  
1520  
1620

**Finishes Available:** Polished

**Material:** Stainless Steel

**Attachment:** Bolt-on

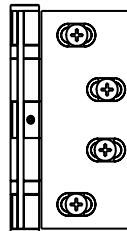
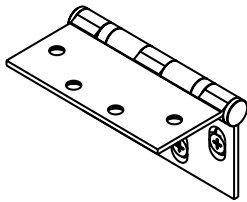

**BUTT HINGE**  
fixed stop or adjustable stop coamings  
4.5" x 4.5"

**Available on Door:** 1110  
1120  
1420  
1510  
1520  
1610  
1620

**Finishes Available:** Polished  
Satin

**Material:** Stainless Steel

**Attachment:** Bolt-on

(1X10 series requires butt hinge)

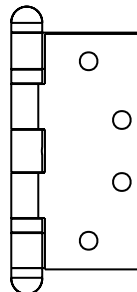
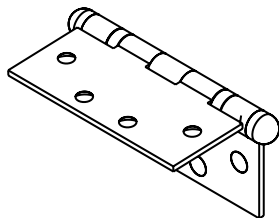

**BUTT HINGE, WITH DOME PIN**  
adjustable stop coamings  
4.5" x 4.5", 6.0" x 4.5", 8.0" x 6.0"

**Available on Door:** 1120  
1420  
1520  
1620

**Finishes Available:** Polished

**Material:** Stainless Steel

**Attachment:** Bolt-on

**Scale** None

© ALL RIGHTS RESERVED  
2010 FREEMAN MARINE EQUIPMENT, INC.  
SPECIFICATIONS SUBJECT TO CHANGE WITHOUT NOTICE

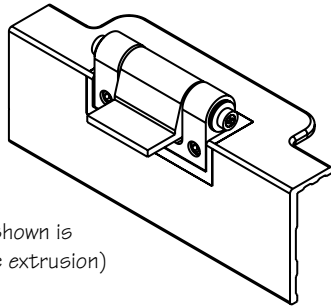

(Hinge shown is in flange extrusion)

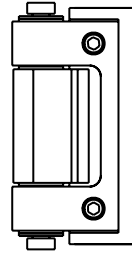

**FLUSH HINGE**

**Available on Door:** 1120  
1130  
1420  
1430  
1432  
1520  
1620

**Finishes Available:** Painted  
Vibratory

**Material:** Aluminum

**Attachment:** Weld-on

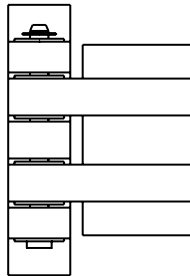
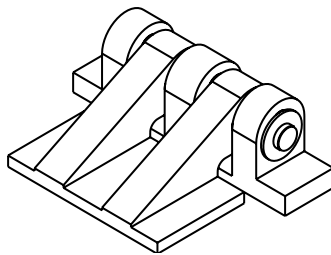

**BLADE HINGE**

**Available on Door:** 1120  
1130  
1420  
1430  
1432  
1520  
1620

**Finishes Available:** Painted  
Vibratory

**Material:** Aluminum

**Attachment:** Weld-on  
Bolt-to-coaming

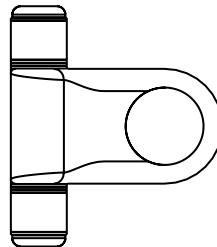
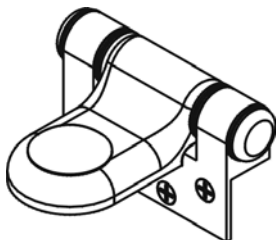

**EURO HINGE**

**Available on Door:** 1120  
1130  
1420  
1430  
1432  
1520  
1620

**Finishes Available:** Painted  
Vibratory

**Material:** Aluminum

**Attachment:** Bolt-on

NOTE: Yoke hinges remain in clear opening space even though door panel swings completely out of opening. Maximum opening 97°.

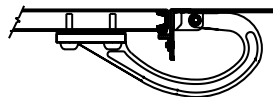
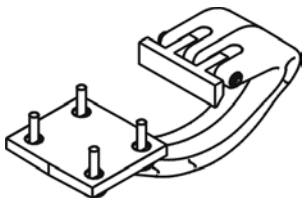

**YOKE HINGE (Concealed)**

universal, with rubber bumpers

**Available on Door:** 1120  
1130  
1420  
1430  
1432  
1620

**Finishes Available:** Polished  
Painted  
Vibratory

**Material:** Aluminum

**Attachment:** Bolt-on

**Scale** None

© ALL RIGHTS RESERVED  
2010 FREEMAN MARINE EQUIPMENT, INC.  
SPECIFICATIONS SUBJECT TO CHANGE WITHOUT NOTICE

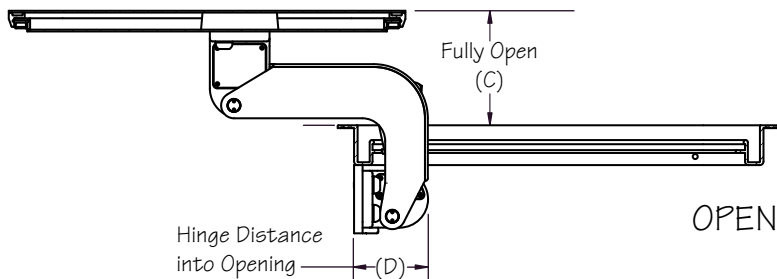
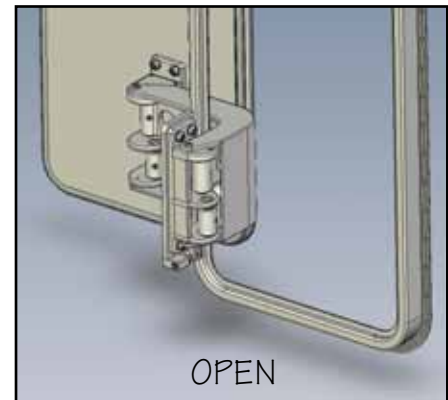
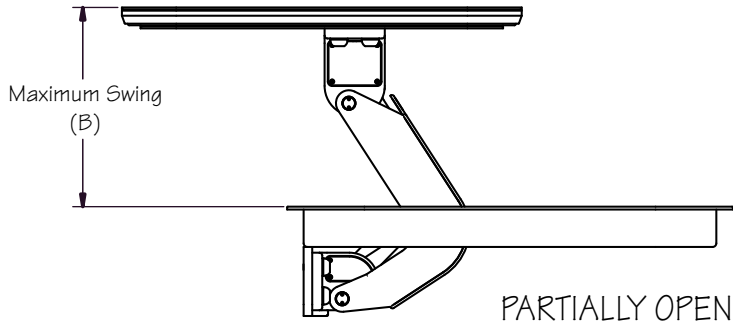
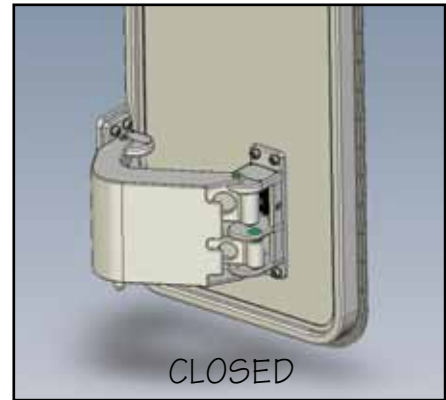
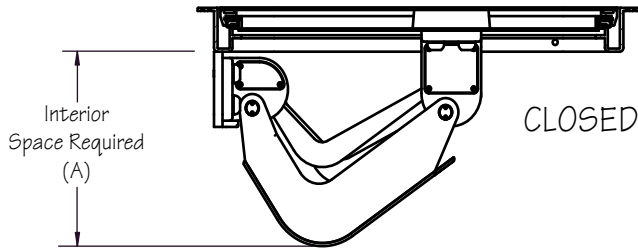

Illustrations represent a typical standard configuration, basic pantograph hinge. Specially sized and/or featured pantograph hinges are available by special quote. Contact Freeman Marine Sales Department with your requirements.

**PANTOGRAPH HINGE - Premium Duty**

	<b>For Rough Opening Size</b> (minimum-to-maximum range)	in. mm.	24~27 610~690	27~38.5 690~980	38.5~46.5 980~1190
	<b>Pantograph Arm Length</b> (measured at pivot point C/L of arms)	in. mm.	14 360	17 440	23 590
<b>A</b>	<b>Interior Space Required</b> (outer most edge of hinge mount-to-inner most point of hinge)	in. mm.	14.8 380	15.8 410	17.6 450
<b>B</b>	<b>Maximum Swing</b> (outward, measured wall-to-face of standard panel)	in. mm.	14.3 370	17.3 440	23.7 610
<b>C</b>	<b>Fully Open</b> (face of door-to-outer face of wall)	in. mm.	10.1 260	10.1 260	10.9 280
<b>D</b>	<b>Hinge Distance into Opening</b> (rough opening-to-inner most point of arm in fully open position)	in. mm.	7 180	7 180	8 210

Scale None

© ALL RIGHTS RESERVED  
2010 FREEMAN MARINE EQUIPMENT, INC.  
SPECIFICATIONS SUBJECT TO CHANGE WITHOUT NOTICE