



barka.it

Products
Prodotti 2020

Attrezzature
e accessori per la nautica

Equipment
and accessories for boating





Vimodrone (MI)



Villongo (BG)

Benvenuti a bordo!

BARKA opera dal 1966 con successo nel settore della nautica da diporto: dalla vendita di barche a vela, sua principale attività originaria, si è via via specializzata nella **produzione e distribuzione di attrezzature e accessori nautici.**

Con sede principale a Milano, un'unità produttiva a Bergamo e distributori all'estero, nel corso dei suoi **50 anni di attività** si è affermata come una delle realtà più serie, affidabili e versatili del settore, diventando punto di riferimento per gli approvvigionamenti da parte dei principali cantieri e operatori nazionali ed internazionali.

Suo punto di forza è, innanzitutto, l'**unicità** degli articoli di propria produzione: il **TEAK WONDER**, linea di prodotti leader a livello internazionale nel settore dei prodotti di pulizia e cura del teak, ed i **SUPPORTI** e gli **ATTUATORI ELETTRICI**, venduti in tutto il mondo anche in versioni **personalizzate.**

BARKA si distingue inoltre per l'**elevata qualità** dei prodotti per la nautica che distribuisce (rubinetti, lavelli, raccordi, pompe, filtri, ecc), dei quali può offrire una gamma in grado di soddisfare ogni tipo di esigenza.

Welcome on board!

Since 1966 BARKA operates successfully in the field of pleasure boating: from sale of sailboats, its main original activity, it has gradually specialized in the **production and distribution of marine equipment and accessories.**

Headquartered in Milan, a production unit in Bergamo and distributors abroad, during its **50 years activity** it has established itself as one of the most serious, reliable and versatile realities in the industry, becoming a point of reference for supplies for major national and international shipyards and operators.

Its strength is, first of all, the **uniqueness** of the articles of its production: the **TEAK WONDER**, product line which is internationally leader in the field of cleaning and care of the teak, and **SUPPORTS** and **ELECTRIC STRUTS**, sold around the world also in customized versions.

Moreover, BARKA is distinguished by the **high quality** of marine products that distributes (faucets, sinks, fittings, pumps, filters, etc.), of which it can provide a range that will satisfy every need.



SUPPORTI TAVOLO ELETTRICI / ELECTRIC TABLE PEDESTALS

TELESCOPICO A DUE STADI / TWO STAGES TELESCOPIC > 18898

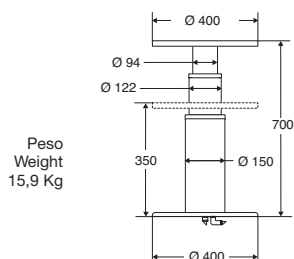

Peso
Weight
15,9 Kg

Costruzione in alluminio lucidato e anodizzato
Alimentazione a 12V-10A o 24V-5A (a richiesta)
Spinta 100 Kg - Velocità 16 mm/sec - corsa 350 mm
Centralina elettronica di controllo inclusa

Built in polished, brightened and anodized light alloy
Powered with 12V-10A or 24V-5A (on request)
Push 100 Kg - Speed 16 mm/sec - stroke 350 mm
Electronic control box included

18898/12 12 Volt

cod. 08.02.01212

18898/24 24 Volt

cod. 08.02.01224

TELESCOPICO A DUE STADI / TWO STAGES TELESCOPIC > 18498

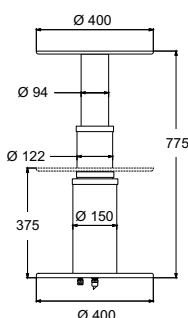

Costruzione in alluminio lucidato e anodizzato
Alimentazione a 12V-10A o 24V-5A (a richiesta)
Spinta 100 Kg - Velocità 16 mm/sec - corsa 400 mm
Centralina elettronica di controllo inclusa

Built in polished, brightened and anodized light alloy
Powered with 12V-10A or 24V-5A (on request)
Push 100 Kg - Speed 16 mm/sec - stroke 400 mm
Electronic control box included

18498/12 12 Volt

cod. 08.02.01350

18498/24 24 Volt

cod. 08.02.01355

TELESCOPICO A DUE STADI / TWO STAGES TELESCOPIC > 18598

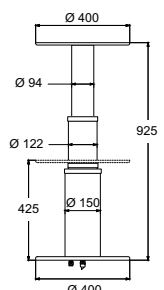

Costruzione in alluminio lucidato e anodizzato
Alimentazione a 12V-10A o 24V-5A (a richiesta)
Spinta 100 Kg - Velocità 16 mm/sec - corsa 500 mm
Centralina elettronica di controllo inclusa

Built in polished, brightened and anodized light alloy
Powered with 12V-10A or 24V-5A (on request)
Push 100 Kg - Speed 16 mm/sec - stroke 500 mm
Electronic control box included

18598/12 12 Volt

cod. 08.02.01360

18598/24 24 Volt

cod. 08.02.01365

TELESCOPICO A DUE STADI / TWO STAGES TELESCOPIC > 18898/G

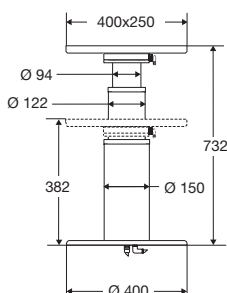

Costruzione in alluminio lucidato e anodizzato
Alimentazione a 12V-10A o 24V-5A (a richiesta)
La testa ruota su 360° con sistema di blocco ogni 90°
Spinta 100 Kg - Velocità 16 mm/sec - corsa 350 mm
Centralina elettronica di controllo inclusa

Built in polished, brightened and anodized light alloy
Powered with 12V-10A or 24V-5A (on request)
The head can swivel on 360° and can be locked at 90° steps to allow to choose the best table position
Push 100 Kg - Speed 16 mm/sec - stroke 350 mm
Electronic control box included

18898/G/12 12 Volt

cod. 08.02.11212

18898/G/24 24 Volt

cod. 08.02.11224

Tutte le misure sono espresse in mm / All measurements are in millimeters

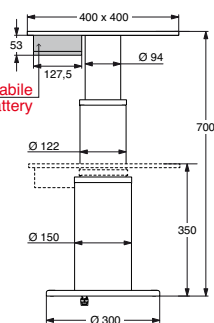
TELESCOPICO A DUE STADI / TWO STAGES TELESCOPIC > **CON BATTERIA / WITH BATTERY B18818**NOVITÀ
NEWBatteria ricaricabile
Rechargeable battery

B18818

cod. 08.02.02001

Supporto a batteria senza cablaggi

Autonomia più di 40 movimentazioni complete

Durata carica della batteria: 1 anno

Ricarica completa della batteria in 3 ore

Completo di telecomando e cavo per ricarica

Integrated Battery powered portable pedestal

Raise & lower up to 40 times per charge

Battery lasts up to 1 year without use

Full recharge in less than 3 hours

Supplied with remote control and charging cable

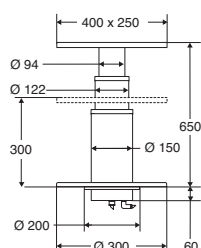
TELESCOPICO A DUE STADI / TWO STAGES TELESCOPIC > **18998/35/30**Peso
Weight
12,9 Kg

18998/35/30/12

12 Volt

cod. 08.02.21212

18998/35/30/24

24 Volt

cod. 08.02.21224

Costruzione in alluminio lucidato e anodizzato

Alimentazione a 12V-10A o 24V-5A (a richiesta)

Con sporgenza sotto pavimento

Spinta 100 Kg - Velocità 16 mm/sec - corsa 350 mm

Centralina elettronica di controllo inclusa

Built in polished, brightened and anodized light alloy

Powered with 12V-10A or 24V-5A (on request)

With underfloor protrusion

Push 100 Kg - Speed 16 mm/sec - stroke 350 mm

Electronic control box included

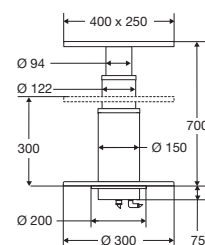
TELESCOPICO A DUE STADI / TWO STAGES TELESCOPIC > **18998/40/30**Peso
Weight
13,2 Kg

18998/40/30/12

12 Volt

cod. 08.02.21312

18998/40/30/24

24 Volt

cod. 08.02.21324

Costruzione in alluminio lucidato e anodizzato

Alimentazione a 12V-10A o 24V-5A (a richiesta)

Con sporgenza sotto pavimento

Spinta 100 Kg - Velocità 16 mm/sec - corsa 400 mm

Centralina elettronica di controllo inclusa

Built in polished, brightened and anodized light alloy

Powered with 12V-10A or 24V-5A (on request)

With underfloor protrusion

Push 100 Kg - Speed 16 mm/sec - stroke 400 mm

Electronic control box included

Tutte le misure sono espresse in mm / All measurements are in millimeters

SUPPORTI TAVOLO ELETTRICI / ELECTRIC TABLE PEDESTALS

TELESCOPICO A DUE STADI / TWO STAGES TELESCOPIC > 18898 HT



Peso
Weight
19,3 Kg

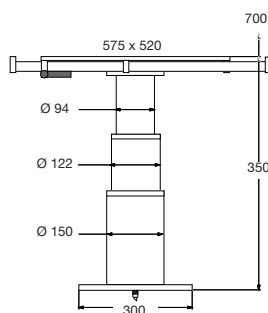

Costruzione in alluminio lucidato e anodizzato
Alimentazione a 12V-10A o 24V-5A (a richiesta)
Con supporto tavolo allungabile
Spinta 100 Kg - Velocità 16 mm/sec - corsa 350 mm
Centralina elettronica di controllo inclusa

Built in polished, brightened and anodized light alloy
Powered with 12V-10A or 24V-5A (on request)
With table support with extensions
Push 100 Kg - Speed 16 mm/sec - stroke 350 mm
Electronic control box included

18898 HT/12 12 Volt

cod. 08.02.01251

TELESCOPICO A DUE STADI / TWO STAGES TELESCOPIC > 188 HT

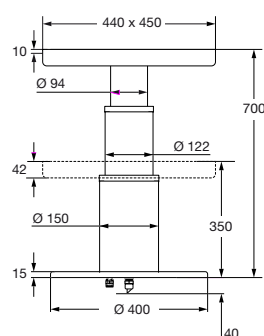

Costruzione in alluminio lucidato e anodizzato
Alimentazione a 12V-10A o 24V-5A (a richiesta)
Con piastra superiore scorrevole, traslazione 200 mm per regolare distanza del tavolo dalla seduta
Spinta 100 Kg - Velocità 16 mm/sec
Centralina elettronica di controllo inclusa

Built in polished, brightened and anodized light alloy
Powered with 12V-10A or 24V-5A (on request)
Sliding upper plate, 200 mm stroke to adjust table distance from seating
Push 100 Kg - Speed 16 mm/sec
Electronic control box included

188 HT/12 12 Volt

cod. 08.02.11242

188 HT/24 24 Volt

cod. 08.02.11244

TELESCOPICO A DUE STADI / TWO STAGES TELESCOPIC > 189 HT/35/30

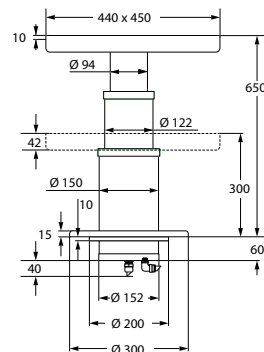

Costruzione in alluminio lucidato e anodizzato
Alimentazione a 12V-10A o 24V-5A (a richiesta)
Con piastra superiore scorrevole, traslazione 200 mm per regolare distanza del tavolo dalla seduta
Spinta 100 Kg - Velocità 16 mm/sec
Centralina elettronica di controllo inclusa

Built in polished, brightened and anodized light alloy
Powered with 12V-10A or 24V-5A (on request)
Sliding upper plate, 200 mm stroke to adjust table distance from seating
Push 100 Kg - Speed 16 mm/sec
Electronic control box included

189 HT/35/30/12 12 Volt

cod. 08.02.21242

189 HT/35/30/24 24 Volt

cod. 08.02.21244

TELESCOPICO A DUE STADI / TWO STAGES TELESCOPIC > 189 HT/40/30

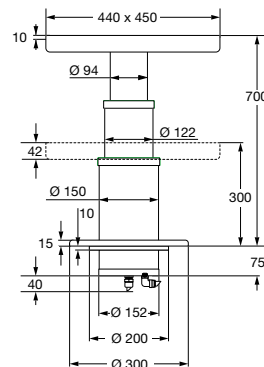

Costruzione in alluminio lucidato e anodizzato
Alimentazione a 12V-10A o 24V-5A (a richiesta)
Con piastra superiore scorrevole, traslazione 200 mm per regolare distanza del tavolo dalla seduta
Spinta 100 Kg - Velocità 16 mm/sec
Centralina elettronica di controllo inclusa

Built in polished, brightened and anodized light alloy
Powered with 12V-10A or 24V-5A (on request)
Sliding upper plate, 200 mm stroke to adjust table distance from seating
Push 100 Kg - Speed 16 mm/sec
Electronic control box included

189 HT/40/30/12 12 Volt

cod. 08.02.21342

189 HT/40/30/24 24 Volt

cod. 08.02.21344

Tutte le misure sono espresse in mm / All measurements are in millimeters

TELESCOPICO A DUE STADI / TWO STAGES TELESCOPIC > 12398

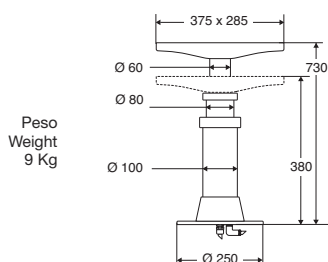

Peso
Weight
9 Kg

Costruzione in alluminio lucidato e anodizzato
Alimentazione a 12V-10A o 24V-5A (a richiesta)
Spinta 100 Kg - Velocità 16 mm/sec - corsa 350 mm
Centralina elettronica di controllo inclusa

Built in polished, brightened and anodized light alloy
Powered with 12V-10A or 24V-5A (on request)
Push 100 Kg - Speed 16 mm/sec - stroke 350 mm
Electronic control box included

12398/12 12 Volt

cod. 08.01.00212

12398/24 24 Volt

cod. 08.01.00224

TELESCOPICO A DUE STADI / TWO STAGES TELESCOPIC > 12398/35

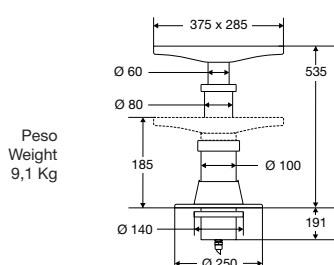

Peso
Weight
9,1 Kg

Costruzione in alluminio lucidato e anodizzato
Alimentazione a 12V-10A o 24V-5A (a richiesta)
Con sporgenza sotto pavimento regolabile
Spinta 100 Kg - Velocità 16 mm/sec - corsa 350 mm
Centralina elettronica di controllo inclusa

Built in polished, brightened and anodized light alloy
Powered with 12V-10A or 24V-5A (on request)
With underfloor adjustable protrusion
Push 100 Kg - Speed 16 mm/sec - stroke 350 mm
Electronic control box included

12398/35/12 12 Volt

cod. 08.01.01212

12398/35/24 24 Volt

cod. 08.01.01224

TELESCOPICO A DUE STADI / TWO STAGES TELESCOPIC > 12398/40

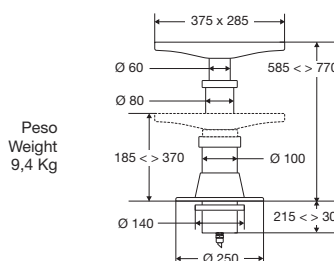

Peso
Weight
9,4 Kg

Costruzione in alluminio lucidato e anodizzato
Alimentazione a 12V-10A o 24V-5A (a richiesta)
Con sporgenza sotto pavimento regolabile
Spinta 100 Kg - Velocità 16 mm/sec - corsa 350 mm
Centralina elettronica di controllo inclusa

Built in polished, brightened and anodized light alloy
Powered with 12V-10A or 24V-5A (on request)
With underfloor adjustable protrusion
Push 100 Kg - Speed 16 mm/sec - stroke 350 mm
Electronic control box included

12398/40/12 12 Volt

cod. 08.01.01312

12398/40/24 24 Volt

cod. 08.01.01324

ATTENZIONE!

NON utilizzare sistemi di pulizia con acqua in pressione: potrebbero causare infiltrazioni e conseguenti malfunzionamenti dei supporti elettrici. Barka non garantisce i supporti sottoposti a pulizia con acqua in pressione.

CAUTION!

DO NOT PRESSURE WASH electric pedestals. Pedestals must NOT be subjected to water pressure because they may experience water intrusion and subsequent failure. Pressure washing will invalidate the warranty for those products.

Tutte le misure sono espresse in mm / All measurements are in millimeters

MULTIPLI / MULTIPLE LEGS

TELESCOPICO A DUE STADI / TWO STAGES TELESCOPIC

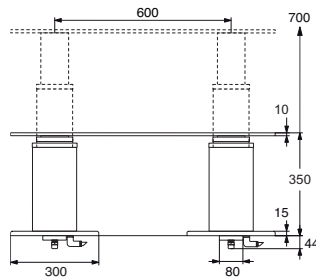

E18899/12	12 Volt
E18899/24	24 Volt
E188983/12	12 Volt
E188983/24	24 Volt
E188984/12	12 Volt
E188984/24	24 Volt

Con encoder

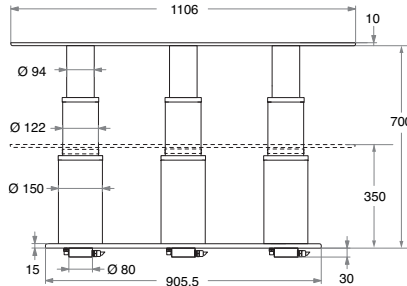

Costruzione in alluminio lucidato e anodizzato
Alimentazione a 12V-10A o 24V-5A (a richiesta)
Spinta 200 Kg - Velocità 16 mm/sec - corsa 350 mm
Centralina elettronica di controllo inclusa con tastiera di regolazione e movimentazione

Built in polished, brightened and anodized light alloy
Powered with 12V-10A or 24V-5A (on request)
Push 200 Kg - Speed 16 mm/sec - stroke 350 mm

Electronic control box and keyboard for set-up and movement included

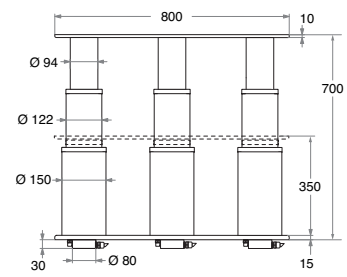

cod. 08.02.01312
cod. 08.02.01324
cod. 08.02.01412
cod. 08.02.01424
cod. 08.02.01512
cod. 08.02.01524

With encoder

SUPPORTI TAVOLO ELETTRICI / ELECTRIC TABLE PEDESTALS

TELESCOPICO A UNO STADIO / ONE STAGES TELESCOPIC > 18198

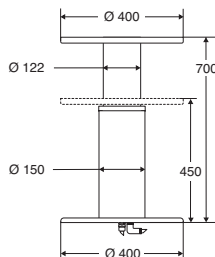

18198/12	12 Volt
18198/24	24 Volt

Costruzione in alluminio lucidato e anodizzato
Alimentazione a 12V-8A o 24V-4A (a richiesta)
Spinta 100 Kg - Velocità 16 mm/sec - corsa 250 mm
Centralina elettronica di controllo inclusa

Built in polished, brightened and anodized light alloy
Powered with 12V-8A or 24V-4A (on request)
Push 100 Kg - Speed 16 mm/sec - stroke 250 mm
Electronic control box included

cod. 08.02.00012
cod. 08.02.00024

TELESCOPICO A UNO STADIO / ONE STAGES TELESCOPIC > 18298

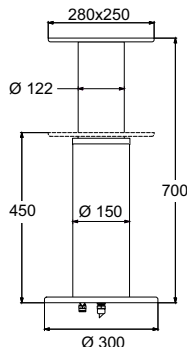

18298/12	12 Volt
18298/24	24 Volt

Costruzione in alluminio lucidato e anodizzato
Alimentazione a 12V-8A o 24V-4A (a richiesta)
Spinta 100 Kg - Velocità 16 mm/sec - corsa 250 mm
Centralina elettronica di controllo inclusa

Built in polished, brightened and anodized light alloy
Powered with 12V-8A or 24V-4A (on request)
Push 100 Kg - Speed 16 mm/sec - stroke 250 mm
Electronic control box included

cod. 08.02.00030
cod. 08.02.00035

Tutte le misure sono espresse in mm / All measurements are in millimeters

SUPPORTI TAVOLO ELETTRICI / ELECTRIC TABLE PEDESTALS

TELESCOPICO A UNO STADIO / ONE STAGE TELESCOPIC > 18398

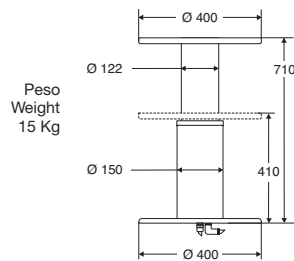

Peso
Weight
15 Kg

Costruzione in alluminio lucidato e anodizzato
Alimentazione a 12V-10A o 24V-5A (a richiesta)
Spinta 100 Kg - Velocità 16 mm/sec - corsa 300 mm
Centralina elettronica di controllo inclusa

Built in polished, brightened and anodized light alloy
Powered with 12V-10A or 24V-5A (on request)
Push 100 Kg - Speed 16 mm/sec - stroke 300 mm
Electronic control box included

18398/12 12 Volt

cod. 08.02.00112

18398/24 24 Volt

cod. 08.02.00124

TELESCOPICO A UNO STADIO / ONE STAGE TELESCOPIC > 18197

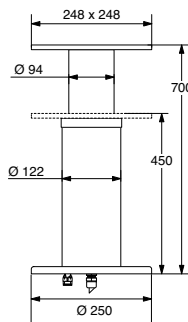

Costruzione in alluminio lucidato e anodizzato
Alimentazione a 12V-8A o 24V-4A (a richiesta)
Spinta 100 Kg - Velocità 16 mm/sec - corsa 250 mm
Centralina elettronica di controllo inclusa

Built in polished, brightened and anodized light alloy
Powered with 12V-8A or 24V-4A (on request)
Push 100 Kg - Speed 16 mm/sec - stroke 250 mm
Electronic control box included

18197/12 12 Volt

cod. 08.03.00012

18197/24 24 Volt

cod. 08.03.00024

TELESCOPICO A UNO STADIO / ONE STAGE TELESCOPIC > 18997/40/30

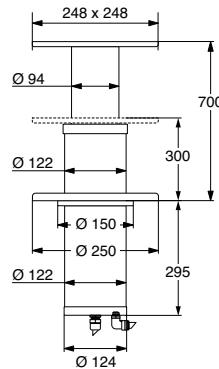

Costruzione in alluminio lucidato e anodizzato
Alimentazione a 12V-8A o 24V-4A (a richiesta)
Con sporgenza sotto pavimento
Spinta 100 Kg - Velocità 16 mm/sec - corsa 400 mm
Centralina elettronica di controllo inclusa

Built in polished, brightened and anodized light alloy
Powered with 12V-8A or 24V-4A (on request)
With underfloor protrusion
Push 100 Kg - Speed 16 mm/sec - stroke 400 mm
Electronic control box included

18997/40/30/12 12 Volt

cod. 08.03.00112

18997/40/30/24 24 Volt

cod. 08.03.00124



Tutte le misure sono espresse in mm / All measurements are in millimeters

SUPPORTI TAVOLO ELETTRICI / ELECTRIC TABLE PEDESTALS

TELESCOPICO A UNO STADIO / ONE STAGE TELESCOPIC > 12197



Peso
Weight
10,6 Kg

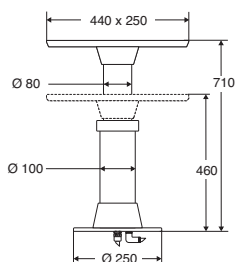

Costruzione in alluminio lucidato e anodizzato
Alimentazione a 12V-8A o 24V-4A (a richiesta)
Spinta 100 Kg - Velocità 16 mm/sec - corsa 250 mm
Centralina elettronica di controllo inclusa

Built in polished, brightened and anodized light alloy
Powered with 12V-8A or 24V-4A (on request)
Push 100 Kg - Speed 16 mm/sec - stroke 250 mm
Electronic control box included

12197/12 12 Volt

cod. 08.05.00012

12197/24 24 Volt

cod. 08.05.00024

TELESCOPICO A UNO STADIO / ONE STAGE TELESCOPIC > 12197/G

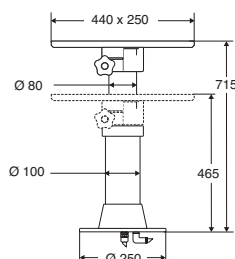

Costruzione in alluminio lucidato e anodizzato
Alimentazione a 12V-8A o 24V-4A (a richiesta)
Spinta 100 Kg - Velocità 16 mm/sec - corsa 250 mm
Centralina elettronica di controllo inclusa

Built in polished, brightened and anodized light alloy
Powered with 12V-8A or 24V-4A (on request)
Push 100 Kg - Speed 16 mm/sec - stroke 250 mm
Electronic control box included

12197/G/12 12 Volt

cod. 08.05.10012

12197/G/24 24 Volt

cod. 08.05.10024

TELESCOPICO A UNO STADIO / ONE STAGE TELESCOPIC > 12198



Peso
Weight
6,9 Kg

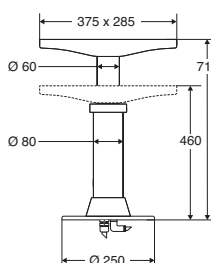

Costruzione in alluminio lucidato e anodizzato
Alimentazione a 12V-8A o 24V-4A (a richiesta)
Spinta 100 Kg - Velocità 16 mm/sec - corsa 250 mm
Centralina elettronica di controllo inclusa

Built in polished, brightened and anodized light alloy
Powered with 12V-8A or 24V-4A (on request)
Push 100 Kg - Speed 16 mm/sec - stroke 250 mm
Electronic control box included

12198/12 12 Volt

cod. 08.05.20012

12198/24 24 Volt

cod. 08.05.20024

TELESCOPICO A UNO STADIO / ONE STAGE TELESCOPIC > 12199



Peso
Weight
8,4 Kg

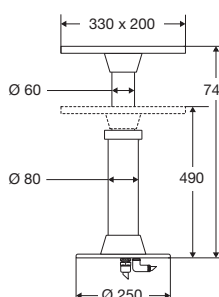

Costruzione in alluminio lucidato e anodizzato
Alimentazione a 12V-8A o 24V-4A (a richiesta)
Spinta 100 Kg - Velocità 16 mm/sec - corsa 250 mm
Centralina elettronica di controllo inclusa

Built in polished, brightened and anodized light alloy
Powered with 12V-8A or 24V-4A (on request)
Push 100 Kg - Speed 16 mm/sec - stroke 250 mm
Electronic control box included

12199/12 12 Volt

cod. 08.05.30012

12199/24 24 Volt

cod. 08.05.30024

Tutte le misure sono espresse in mm / All measurements are in millimeters

TELESCOPICO A UNO STADIO / ONE STAGE TELESCOPIC > 12297/35



Peso
Weight
11 Kg

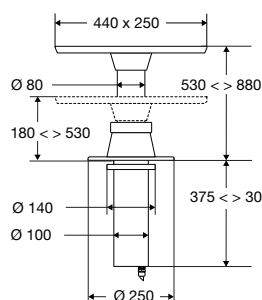

Costruzione in alluminio lucidato e anodizzato
Alimentazione a 12V-8A o 24V-4A (a richiesta)
Con sporgenza sotto pavimento regolabile
Spinta 100 Kg - Velocità 16 mm/sec - corsa 350 mm
Centralina elettronica di controllo inclusa

Built in polished, brightened and anodized light alloy
Powered with 12V-8A or 24V-4A (on request)
With underfloor adjustable protrusion
Push 100 Kg - Speed 16 mm/sec - stroke 350 mm
Electronic control box included

12297/35/12

12 Volt

cod. 08.05.01212

12297/35/24

24 Volt

cod. 08.05.01224

TELESCOPICO A UNO STADIO / ONE STAGE TELESCOPIC > 12297/35/G



Peso
Weight
11,8 Kg

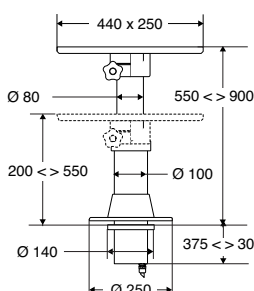

Costruzione in alluminio lucidato e anodizzato
Alimentazione a 12V-8A o 24V-4A (a richiesta)
con sporgenza sotto pavimento regolabile
e testa girevole
Spinta 100 Kg - Velocità 16 mm/sec - corsa 350 mm
Centralina elettronica di controllo inclusa

Built in polished, brightened and anodized light alloy
Powered with 12V-8A or 24V-4A (on request)
with underfloor adjustable protrusion and swivel head
Push 100 Kg - Speed 16 mm/sec - stroke 350 mm
Electronic control box included

12297/35/G/12

12 Volt

cod. 08.05.11212

12297/35/G/24

24 Volt

cod. 08.05.11224

TELESCOPICO A UNO STADIO / ONE STAGE TELESCOPIC > 12297/40

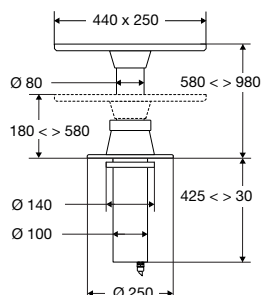

Costruzione in alluminio lucidato e anodizzato
Alimentazione a 12V-8A o 24V-4A (a richiesta)
con sporgenza sotto pavimento regolabile
Spinta 100 Kg - Velocità 16 mm/sec - corsa 400 mm
Centralina elettronica di controllo inclusa

Built in polished, brightened and anodized light alloy
Powered with 12V-8A or 24V-4A (on request)
with underfloor adjustable protrusion
Push 100 Kg - Speed 16 mm/sec - stroke 400 mm
Electronic control box included

12297/40/12

12 Volt

cod. 08.05.01312

12297/40/24

24 Volt

cod. 08.05.01324

TELESCOPICO A UNO STADIO / ONE STAGE TELESCOPIC > 12297/40/G

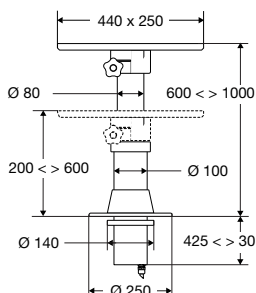

Costruzione in alluminio lucidato e anodizzato
Alimentazione a 12V-8A o 24V-4A (a richiesta)
con sporgenza sotto pavimento regolabile
e testa girevole
Spinta 100 Kg - Velocità 16 mm/sec - corsa 400 mm
Centralina elettronica di controllo inclusa

Built in polished, brightened and anodized light alloy
Powered with 12V-8A or 24V-4A (on request)
with underfloor adjustable protrusion and swivel head
Push 100 Kg - Speed 16 mm/sec - stroke 400 mm
Electronic control box included

12297/40/G/12

12 Volt

cod. 08.05.11312

12297/40/G/24

24 Volt

cod. 08.05.11324

Tutte le misure sono espresse in mm / All measurements are in millimeters

SUPPORTI TAVOLO ELETTRICI / ELECTRIC TABLE PEDESTALS

TELESCOPICO A UNO STADIO / ONE STAGE TELESCOPIC > 12298/35

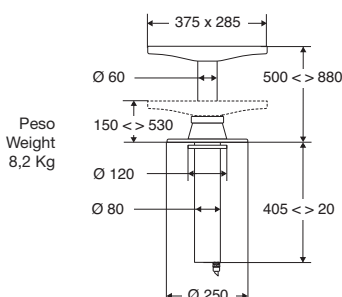

Peso
Weight
8,2 Kg

Costruzione in alluminio lucidato e anodizzato
Alimentazione a 12V-8A o 24V-4A (a richiesta)
Con sporgenza sotto pavimento regolabile
Spinta 100 Kg - Velocità 16 mm/sec - corsa 350 mm
Centralina elettronica di controllo inclusa

Built in polished, brightened and anodized light alloy
Powered with 12V-8A or 24V-4A (on request)
With underfloor adjustable protrusion
Push 100 Kg - Speed 16 mm/sec - stroke 350 mm
Electronic control box included

12298/35/12

12 Volt

cod. 08.05.21212

12298/35/24

24 Volt

cod. 08.05.21224

TELESCOPICO A UNO STADIO / ONE STAGE TELESCOPIC > 12298/40

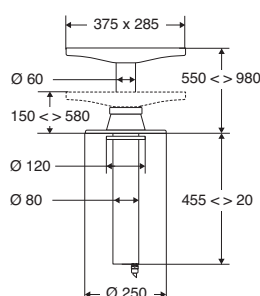

Costruzione in alluminio lucidato e anodizzato
Alimentazione a 12V-8A o 24V-4A (a richiesta)
Con sporgenza sotto pavimento regolabile
Spinta 100 Kg - Velocità 16 mm/sec - corsa 400 mm
Centralina elettronica di controllo inclusa

Built in polished, brightened and anodized light alloy
Powered with 12V-8A or 24V-4A (on request)
With underfloor adjustable protrusion
Push 100 Kg - Speed 16 mm/sec - stroke 400 mm
Electronic control box included

12298/40/12 12 Volt

cod. 08.05.21312

12298/40/24 24 Volt

cod. 08.05.21324

TELESCOPICO A UNO STADIO / ONE STAGE TELESCOPIC > 12299/35

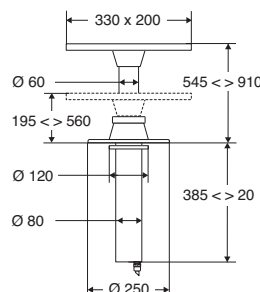

Costruzione in alluminio lucidato e anodizzato
Alimentazione a 12V-8A o 24V-4A (a richiesta)
Con sporgenza sotto pavimento regolabile
Spinta 100 Kg - Velocità 16 mm/sec - corsa 350 mm
Centralina elettronica di controllo inclusa

Built in polished, brightened and anodized light alloy
Powered with 12V-8A or 24V-4A (on request)
With underfloor adjustable protrusion
Push 100 Kg - Speed 16 mm/sec - stroke 350 mm
Electronic control box included

12299/35/12

12 Volt

cod. 08.05.31212

12299/35/24

24 Volt

cod. 08.05.31224

TELESCOPICO A UNO STADIO / ONE STAGE TELESCOPIC > 12299/40

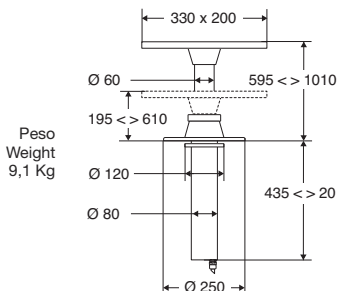

Peso
Weight
9,1 Kg

Costruzione in alluminio lucidato e anodizzato
Alimentazione a 12V-8A o 24V-4A (a richiesta)
Con sporgenza sotto pavimento regolabile
Spinta 100 Kg - Velocità 16 mm/sec - corsa 400 mm
Centralina elettronica di controllo inclusa

Built in polished, brightened and anodized light alloy
Powered with 12V-8A or 24V-4A (on request)
With underfloor adjustable protrusion
Push 100 Kg - Speed 16 mm/sec - stroke 400 mm
Electronic control box included

12299/40/12

12 Volt

cod. 08.05.31312

12299/40/24

24 Volt

cod. 08.05.31324

Tutte le misure sono espresse in mm / All measurements are in millimeters

A SCOMPARSA > TELESCOPICO A UNO STADIO / FLUSH > ONE STAGE TELESCOPIC > 19697

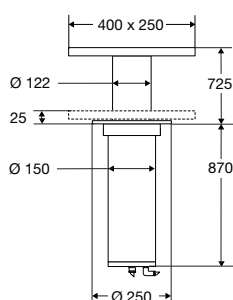

19697/12

12 Volt

cod. 08.02.70012

19697/24

24 Volt

cod. 08.02.70024

Costruzione in alluminio lucidato e anodizzato
Alimentazione a 12V-8A o 24V-4A (a richiesta)
a discesa totale
Spinta 100 Kg - Velocità 16 mm/sec - corsa 700 mm
Centralina elettronica di controllo inclusa

Built in polished, brightened and anodized light alloy
Powered with 12V-8A or 24V-4A (on request)
almost flush to floor
Push 100 Kg - Speed 16 mm/sec - stroke 700 mm
Electronic control box included

A SCOMPARSA > TELESCOPICO A UNO STADIO / FLUSH > ONE STAGE TELESCOPIC > 18191/65

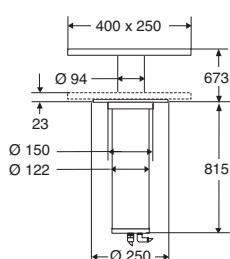

18191/65/12

12 Volt

cod. 08.08.70112

18191/65/24

24 Volt

cod. 08.08.70124

Costruzione in alluminio lucidato e anodizzato
Alimentazione a 12V-8A o 24V-4A (a richiesta)
a discesa totale
Spinta 100 Kg - Velocità 16 mm/sec - corsa 650 mm
Centralina elettronica di controllo inclusa

Built in polished, brightened and anodized light alloy
Powered with 12V-8A or 24V-4A (on request)
almost flush to floor
Push 100 Kg - Speed 16 mm/sec - stroke 650 mm
Electronic control box included

A SCOMPARSA > TELESCOPICO A UNO STADIO / FLUSH > ONE STAGE TELESCOPIC > 18191/70

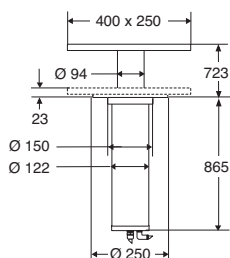

18191/70/12

12 Volt

cod. 08.08.71112

18191/70/24

24 Volt

cod. 08.08.71124

Costruzione in alluminio lucidato e anodizzato
Alimentazione a 12V-8A o 24V-4A (a richiesta)
a discesa totale
Spinta 100 Kg - Velocità 16 mm/sec - corsa 700 mm
Centralina elettronica di controllo inclusa

Built in polished, brightened and anodized light alloy
Powered with 12V-8A or 24V-4A (on request)
almost flush to floor
Push 100 Kg - Speed 16 mm/sec - stroke 700 mm
Electronic control box included



Tutte le misure sono espresse in mm / All measurements are in millimeters

SUPPORTI TAVOLO ELETTRICI / ELECTRIC TABLE PEDESTALS

A SCOMPARSA > TELESCOPICO A DUE STADI / FLUSH > TWO STAGES TELESCOPIC > **18697**

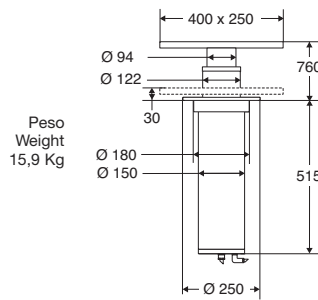

Costruzione in alluminio lucidato e anodizzato
Alimentazione a 12V-10A o 24V-5A (a richiesta)
a discesa totale
Spinta 100 Kg - Velocità 16 mm/sec - corsa 730 mm
Centralina elettronica di controllo inclusa

Built in polished, brightened and anodized light alloy
Powered with 12V-10A or 24V-5A (on request)
almost flush to floor
Push 100 Kg - Speed 16 mm/sec - stroke 730 mm
Electronic control box included

18697/12

12 Volt

cod. 08.02.60012

18697/24

24 Volt

cod. 08.02.60024

A SCOMPARSA > TELESCOPICO A DUE STADI / FLUSH > TWO STAGES TELESCOPIC > **18697/G**

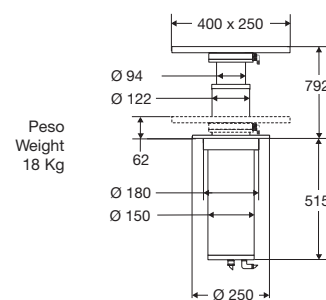

Costruzione in alluminio lucidato e anodizzato
Alimentazione a 12V-10A o 24V-5A (a richiesta)
a discesa totale
Spinta 100 Kg - Velocità 16 mm/sec - corsa 730 mm
Centralina elettronica di controllo inclusa

Built in polished, brightened and anodized light alloy
Powered with 12V-10A or 24V-5A (on request)
almost flush to floor
Push 100 Kg - Speed 16 mm/sec - stroke 730 mm
Electronic control box included

18697/G/12

12 Volt

cod. 08.02.60112

18697/G/24

24 Volt

cod. 08.02.60124

SUPPORTI TAVOLO A GAS / GAS POWERED TABLE PEDESTALS

TELESCOPICO > FISSO / TELESCOPIC > FIXED > **12197/F**

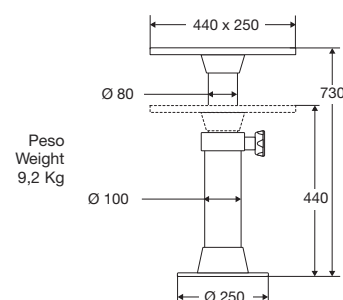

Costruzione in alluminio lucidato e anodizzato
Spinta 30 Kg - Corsa 290 mm
Il pistone può essere bloccato
in ogni posizione intermedia
A manopola sbloccata può ruotare su 360°

Built in polished and anodized light alloy
Push of 30 Kg - Stroke of 290 mm
The piston can be locked in
any intermediate position
When the handle is loose the top
can rotate over 360°

12197/F

cod. 08.10.00000

Tutte le misure sono espresse in mm / All measurements are in millimeters

SUPPORTI TAVOLO A GAS / GAS POWERED TABLE PEDESTALS

TELESCOPICO > FISSO / TELESCOPIC > FIXED > 12193

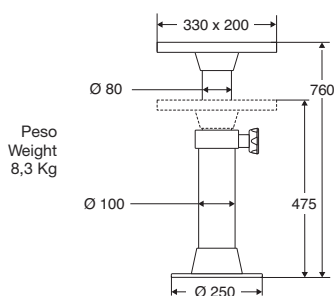

Costruzione in alluminio lucidato e anodizzato
Spinta 30 Kg - Corsa 285 mm
Il pistone può essere bloccato
in ogni posizione intermedia
A manopola sbloccata può ruotare su 360°

Built in polished and anodized light alloy
Push of 30 Kg - Stroke of 285 mm
The piston can be locked in
any intermediate position
When the handle is loose the top
can rotate over 360°

12193

cod. 08.10.00005

TELESCOPICO > FISSO / TELESCOPIC > FIXED > 10103/F/30

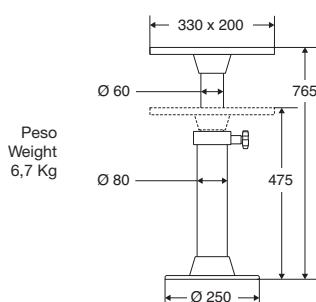

Costruzione in alluminio lucidato e anodizzato
Spinta 30 Kg - Corsa 290 mm
Il pistone può essere bloccato
in ogni posizione intermedia
A manopola sbloccata può ruotare su 360°

Built in polished and anodized light alloy
Push of 30 Kg - Stroke of 290 mm
The piston can be locked in
any intermediate position
When the handle is loose the top
can rotate over 360°

10103/F/30

cod. 08.10.40200

TELESCOPICO > FISSO / TELESCOPIC > FIXED > 10101/F/30

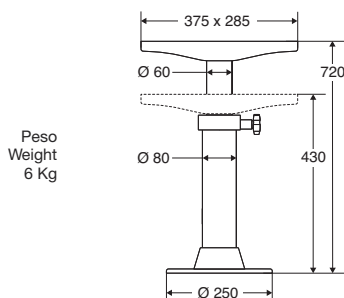

Costruzione in alluminio lucidato e anodizzato
Spinta 30 Kg - Corsa 290 mm
Il pistone può essere bloccato
in ogni posizione intermedia
A manopola sbloccata può ruotare su 360°

Built in polished and anodized light alloy
Push of 30 Kg - Stroke of 290 mm
The piston can be locked in
any intermediate position
When the handle is loose the top
can rotate over 360°

10101/F/30

cod. 08.10.30100

TELESCOPICO > FISSO / TELESCOPIC > FIXED > 10101/F/35

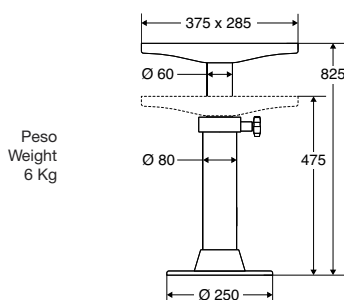

Costruzione in alluminio lucidato e anodizzato
Spinta 30 Kg - Corsa 350 mm
Il pistone può essere bloccato
in ogni posizione intermedia
A manopola sbloccata può ruotare su 360°

Built in polished and anodized light alloy
Push of 30 Kg - Stroke of 350 mm
The piston can be locked in
any intermediate position
When the handle is loose the top
can rotate over 360°

10101/F/35

cod. 08.10.30200

Tutte le misure sono espresse in mm / All measurements are in millimeters

SUPPORTI TAVOLO A GAS / GAS POWERED TABLE PEDESTALS

TELESCOPICO > FISSO / TELESCOPIC > FIXED > 10199/30



Peso
Weight
4,5 Kg

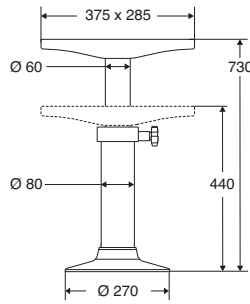

Costruzione in alluminio lucidato e anodizzato
Spinta 30 Kg - Corsa 290 mm
Il pistone può essere bloccato
in ogni posizione intermedia
A manopola sbloccata può ruotare su 360°

Built in polished and anodized light alloy
Push of 30 Kg - Stroke of 290 mm
The piston can be locked in
any intermediate position
When the handle is loose the top
can rotate over 360°

10199/30

cod. 08.16.33100

TELESCOPICO > FISSO / TELESCOPIC > FIXED > 10199/35



Peso
Weight
5,7 Kg

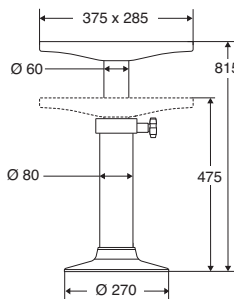

Costruzione in alluminio lucidato e anodizzato
Spinta 30 Kg - Corsa 325 mm
Il pistone può essere bloccato
in ogni posizione intermedia
A manopola sbloccata può ruotare su 360°

Built in polished and anodized light alloy
Push of 30 Kg - Stroke of 325 mm
The piston can be locked in
any intermediate position
When the handle is loose the top
can rotate over 360°

10199/35

cod. 08.16.33200

TELESCOPICO > FISSO / TELESCOPIC > FIXED > 10298/30



Peso
Weight
4,6 Kg

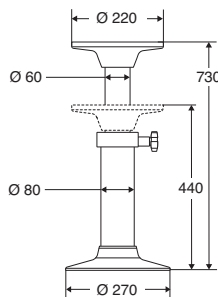

Costruzione in alluminio lucidato e anodizzato
Spinta 30 Kg - Corsa 290 mm
Il pistone può essere bloccato
in ogni posizione intermedia
A manopola sbloccata può ruotare su 360°

Built in polished and anodized light alloy
Push of 30 Kg - Stroke of 290 mm
The piston can be locked in
any intermediate position
When the handle is loose the top
can rotate over 360°

10298/30

cod. 08.16.53100

TELESCOPICO > FISSO / TELESCOPIC > FIXED > 10298/35



Peso
Weight
4,7 Kg

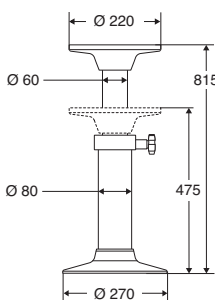

Costruzione in alluminio lucidato e anodizzato
Spinta 30 Kg - Corsa 325 mm
Il pistone può essere bloccato
in ogni posizione intermedia
A manopola sbloccata può ruotare su 360°

Built in polished and anodized light alloy
Push of 30 Kg - Stroke of 325 mm
The piston can be locked in
any intermediate position
When the handle is loose the top
can rotate over 360°

10298/35

cod. 08.16.53200

Tutte le misure sono espresse in mm / All measurements are in millimeters

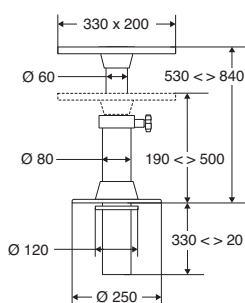
TELESCOPICO > CON SPORGENZA / TELESCOPIC > THROUGH FLOOR > **10103/R/35**

Costruzione in alluminio lucidato e anodizzato
Spinta 30 Kg - Corsa 340 mm
Il pistone può essere bloccato
in ogni posizione intermedia
A manopola sbloccata può ruotare su 360°

Built in polished and anodized light alloy
Push of 30 Kg - Stroke of 340 mm
The piston can be locked in
any intermediate position
When the handle is loose the top
can rotate over 360°

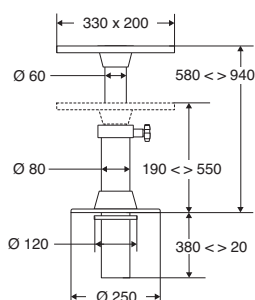
10103/R/35**cod. 08.10.41200**TELESCOPICO > CON SPORGENZA / TELESCOPIC > THROUGH FLOOR > **10103/R/40**

Costruzione in alluminio lucidato e anodizzato
Spinta 30 Kg - Corsa 390 mm
Il pistone può essere bloccato
in ogni posizione intermedia
A manopola sbloccata può ruotare su 360°

Built in polished and anodized light alloy
Push of 30 Kg - Stroke of 390 mm
The piston can be locked in
any intermediate position
When the handle is loose the top
can rotate over 360°

10103/R/40**cod. 08.10.41300**TELESCOPICO > CON SPORGENZA / TELESCOPIC > THROUGH FLOOR > **10101/R/35**

Peso
Weight
6,1 Kg

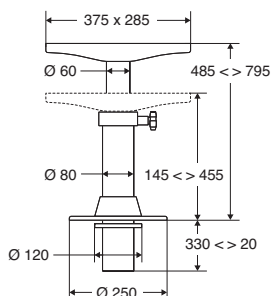

Costruzione in alluminio lucidato e anodizzato
Spinta 30 Kg - Corsa 340 mm
Il pistone può essere bloccato
in ogni posizione intermedia
A manopola sbloccata può ruotare su 360°

Built in polished and anodized light alloy
Push of 30 Kg - Stroke of 340 mm
The piston can be locked in
any intermediate position
When the handle is loose the top
can rotate over 360°

10101/R/35**cod. 08.10.31200**TELESCOPICO > CON SPORGENZA / TELESCOPIC > THROUGH FLOOR > **10101/R/40**

Peso
Weight
6,5 Kg

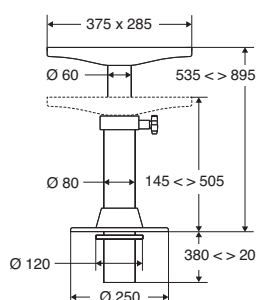

Costruzione in alluminio lucidato e anodizzato
Spinta 30 Kg - Corsa 390 mm
Il pistone può essere bloccato
in ogni posizione intermedia
A manopola sbloccata può ruotare su 360°

Built in polished and anodized light alloy
Push of 30 Kg - Stroke of 390 mm
The piston can be locked in
any intermediate position
When the handle is loose the top
can rotate over 360°

10101/R/40**cod. 08.10.31300**

Tutte le misure sono espresse in mm / All measurements are in millimeters

SUPPORTI TAVOLO A GAS / GAS POWERED TABLE PEDESTALS

TELESCOPICO > CON SPORGENZA / TELESCOPIC > THROUGH FLOOR > **12197/R**

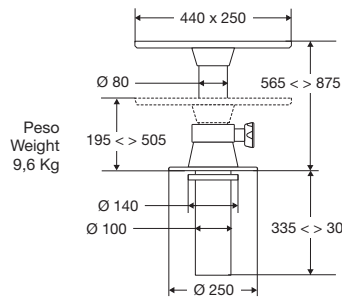

Peso
Weight
9,6 Kg

Costruzione in alluminio lucidato e anodizzato
Spinta 30 Kg - Corsa 370 mm
Il pistone può essere bloccato
in ogni posizione intermedia
A manopola sbloccata può ruotare su 360°

Built in polished and anodized light alloy
Push of 30 Kg - Stroke of 370 mm
The piston can be locked in
any intermediate position
When the handle is loose the top
can rotate over 360°

12197/R

cod. 08.10.01100

TELESCOPICO > MOBILI / TELESCOPIC > MOVABLE > **12197/A**

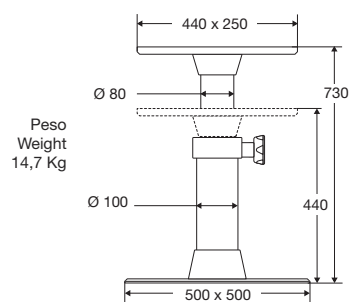

Peso
Weight
14,7 Kg

Costruzione in alluminio lucidato e anodizzato
Spinta 30 Kg - Corsa 290 mm
Il pistone può essere bloccato
in ogni posizione intermedia
A manopola sbloccata può ruotare su 360°

Built in polished and anodized light alloy
Push of 30 Kg - Stroke of 290 mm
The piston can be locked in
any intermediate position
When the handle is loose the top
can rotate over 360°

12197/A

cod. 08.10.02100

TELESCOPICO > MOBILI / TELESCOPIC > MOVABLE > **10101/A/30**

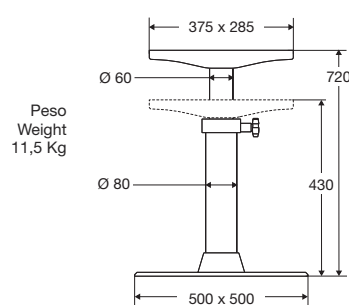

Peso
Weight
11,5 Kg

Costruzione in alluminio lucidato e anodizzato
Spinta 30 Kg - Corsa 290 mm
Il pistone può essere bloccato
in ogni posizione intermedia
A manopola sbloccata può ruotare su 360°

Built in polished and anodized light alloy
Push of 30 Kg - Stroke of 290 mm
The piston can be locked in
any intermediate position
When the handle is loose the top
can rotate over 360°

10101/A/30

cod. 08.10.32100

TELESCOPICO > MOBILI / TELESCOPIC > MOVABLE > **10101/A/35**

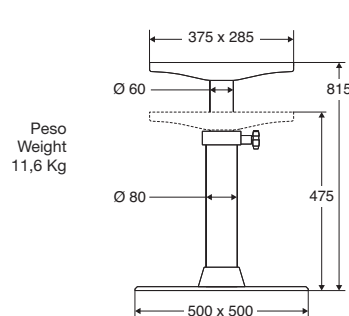

Peso
Weight
11,6 Kg

Costruzione in alluminio lucidato e anodizzato
Spinta 30 Kg - Corsa 340 mm
Il pistone può essere bloccato
in ogni posizione intermedia
A manopola sbloccata può ruotare su 360°

Built in polished and anodized light alloy
Push of 30 Kg - Stroke of 340 mm
The piston can be locked in
any intermediate position
When the handle is loose the top
can rotate over 360°

10101/A/35

cod. 08.10.32200

Tutte le misure sono espresse in mm / All measurements are in millimeters

SUPPORTI TAVOLO MANUALI / MANUAL TABLE PEDESTALS

TELESCOPICO > SENZA SPORGENZA / TELESCOPIC > OVER THE FLOOR > 10199/M/30

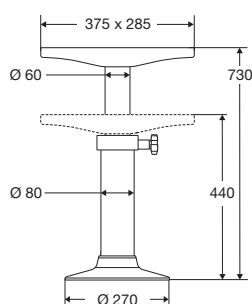

10199/M/30

cod. 08.16.33101

Costruzione in alluminio lucidato e anodizzato
 Corsa 290 mm
 Il pistone può essere bloccato
 in ogni posizione intermedia
 A manopola sbloccata può ruotare su 360°

Built in polished and anodized light alloy
 Stroke of 290 mm
 The piston can be locked in
 any intermediate position
 When the handle is loose the top
 can rotate over 360°

TELESCOPICO > SENZA SPORGENZA / TELESCOPIC > OVER THE FLOOR > 10199/M/35

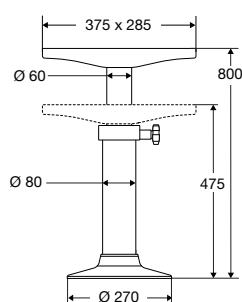

10199/M/35

cod. 08.16.33201

Costruzione in alluminio lucidato e anodizzato
 Corsa 325 mm
 Il pistone può essere bloccato
 in ogni posizione intermedia
 A manopola sbloccata può ruotare su 360°

Built in polished and anodized light alloy
 Stroke of 325 mm
 The piston can be locked in
 any intermediate position
 When the handle is loose the top
 can rotate over 360°

TELESCOPICO > CON SPORGENZA / TELESCOPIC > THROUGH FLOOR > 10512



Peso
 Weight
 3,3 Kg

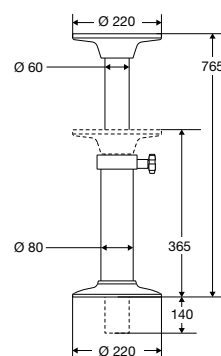

10512

cod. 08.21.00001

Costruzione in alluminio lucidato e anodizzato
 Corsa 400 mm
 Il pistone può essere bloccato
 in ogni posizione intermedia
 A manopola sbloccata può ruotare su 360°

Built in polished and anodized light alloy
 Stroke of 400 mm
 The piston can be locked in
 any intermediate position
 When the handle is loose the top
 can rotate over 360°

TELESCOPICO > CON SPORGENZA / TELESCOPIC > THROUGH FLOOR > 10295



Peso
 Weight
 3,35 Kg

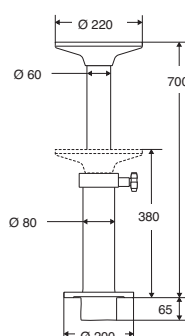

10295

cod. 08.25.30001

10295/35 Senza basi / Without bases – Peso / Weight 1,9 Kg

cod. 08.25.33500

Costruzione in alluminio lucidato e anodizzato
 Amovibile, con base ad incasso
 Corsa 320 mm
 Gamba e base superiore possono essere separati

Built in polished and anodized light alloy
 Removable, with flush deck base
 Stroke of 320 mm
 The post and the upper base can be separated

Tutte le misure sono espresse in mm / All measurements are in millimeters

SUPPORTI TAVOLO SCOMPONIBILI / POST SYSTEM TABLE PEDESTALS

ALTEZZA FISSA / FIXED HEIGHT > 10393



Peso
Weight
4,05 Kg

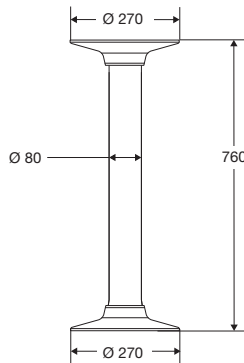

10393

cod. 08.25.10003

Costruzione in alluminio lucidato e anodizzato
Gamba e base superiore possono essere separate

Built in polished and anodized light alloy
The post and the upper base can be separated

ALTEZZA FISSA / FIXED HEIGHT > 10293



Peso
Weight
3,25 Kg

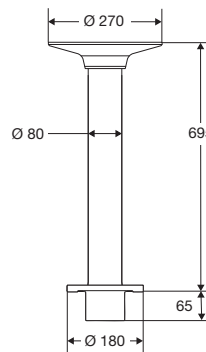

10293

cod. 08.25.10002

Costruzione in alluminio lucidato e anodizzato
Supporto tavolo amovibile con base ad incasso
Gamba e base superiore possono essere separati
Basi compatibili 00106 - 00106/1 - 00109

Built in polished and anodized light alloy
Stowable table pedestal with flush deck base
Matching bases 00106 - 00106/1 - 00109

10193/74 Senza basi / Without bases – Peso / Weight 1,52 Kg

cod. 08.25.17400

ALTEZZA FISSA / FIXED HEIGHT > 10191



Peso
Weight
1,5 Kg

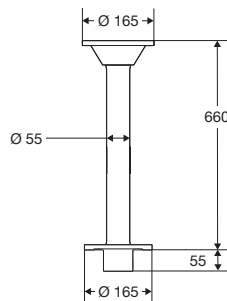

10191

cod. 08.25.00001

10191/70 Senza basi / Without bases – Peso / Weight 665 g

cod. 08.25.07000

Costruzione in alluminio lucidato e anodizzato
Supporto tavolo amovibile con base ad incasso
Gamba e base superiore possono essere separati
Basi compatibili 00102 - 00103 - 00107

Built in polished and anodized light alloy
Stowable table pedestal with flush deck base
The post and the upper base can be separated
Matching bases 00102 - 00103 - 00107

Tutte le misure sono espresse in mm / All measurements are in millimeters

SUPPORTI POLTRONA ELETTRICI / ELECTRIC CHAIR PEDESTALS

TELESCOPICO A UNO STADIO / ONE STAGES TELESCOPIC > 18131

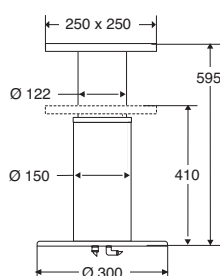

Costruzione in alluminio lucidato e anodizzato
Alimentazione a 12V-10A o 24V-5A (a richiesta)
Spinta 250 Kg - Velocità 16 mm/sec - corsa 185 mm
Centralina elettronica di controllo inclusa

Built in polished, brightened and anodized light alloy
Powered with 12V-10A or 24V-5A (on request)
Push 250 Kg - Speed 16 mm/sec - stroke 185 mm
Electronic control box included

18131/12

cod. 08.32.11012

18131/24

cod. 08.32.11024

TELESCOPICO A UNO STADIO / ONE STAGES TELESCOPIC > 18P97

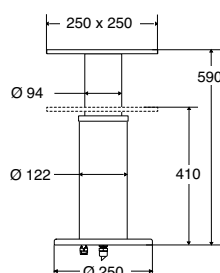

Costruzione in alluminio lucidato e anodizzato
Alimentazione a 12V-10A o 24V-5A (a richiesta)
Spinta 250 Kg - Velocità 16 mm/sec - corsa 180 mm
Centralina elettronica di controllo inclusa

Built in polished, brightened and anodized light alloy
Powered with 12V-10A or 24V-5A (on request)
Push 250 Kg - Speed 16 mm/sec - stroke 180 mm
Electronic control box included

18P97/12

cod. 08.32.15012

18P97/24

cod. 08.32.15024

TELESCOPICO A UNO STADIO / ONE STAGES TELESCOPIC > 18141

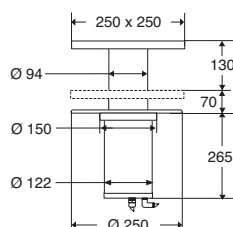

Costruzione in alluminio lucidato e anodizzato
Alimentazione a 12V-10A o 24V-5A (a richiesta)
con sporgenza sotto pavimento
Spinta 250 Kg - Velocità 16 mm/sec - corsa 130 mm
Centralina elettronica di controllo inclusa

Built in polished, brightened and anodized light alloy
Powered with 12V-10A or 24V-5A (on request)
with underfloor protrusion
Push 250 Kg - Speed 16 mm/sec - stroke 130 mm
Electronic control box included

18141/12

cod. 08.32.13012

18141/24

cod. 08.32.13024

TELESCOPICO A UNO STADIO / ONE STAGES TELESCOPIC > 13100



Peso
Weight
8,9 Kg

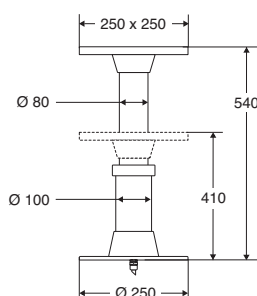

Costruzione in alluminio lucidato e anodizzato
Alimentazione a 12V-10A o 24V-5A (a richiesta)
Spinta 250 Kg - Velocità 16 mm/sec - corsa 130 mm
Centralina elettronica di controllo inclusa

Built in polished, brightened and anodized light alloy
Powered with 12V-10A or 24V-5A (on request)
Push 250 Kg - Speed 16 mm/sec - stroke 130 mm
Electronic control box included

13100/12

cod. 08.32.10012

13100/24

cod. 08.32.10024

Tutte le misure sono espresse in mm / All measurements are in millimeters



SUPPORTI POLTRONA A GAS / GAS POWERED CHAIR PEDESTALS

TELESCOPICO > MANUALE > MONOCOMANDO / TELESCOPIC > MANUAL > ONE HANDLE

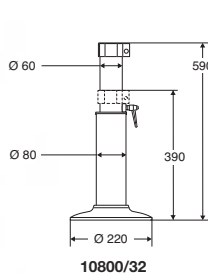

10800/32

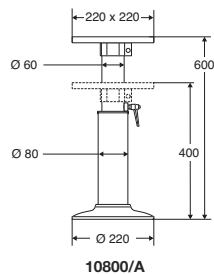

10800/A

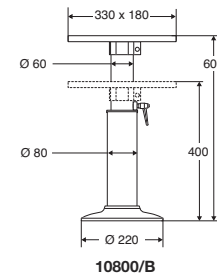

10800/B

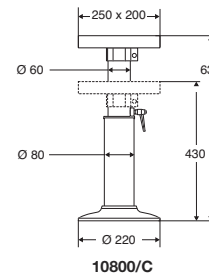

10800/C

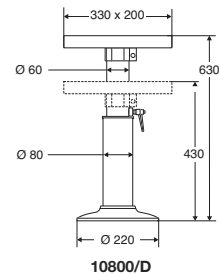

10800/D

10800/32	senza piastra né slitta / without plate or slide	Peso / Weight 2,25 Kg	cod. 08.40.10320
10800/A	con piastra universale / with universal plate	2,885 Kg	cod. 08.40.10001
10800/B	con piastra adatta alle nostre poltrone / with plate suitable for our chairs	2,910 Kg	cod. 08.40.10002
10800/C	con slitta universale / with universal slide	4,050 Kg	cod. 08.40.10003
10800/D	con slitta adatta alle nostre poltrone / with slide suitable for our chairs	4,370 Kg	cod. 08.40.10004

TELESCOPICO > MANUALE > MONOCOMANDO / TELESCOPIC > MANUAL > ONE HANDLE

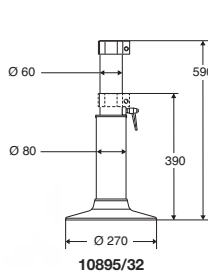

10895/32

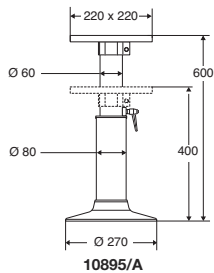

10895/A

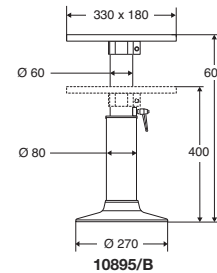

10895/B

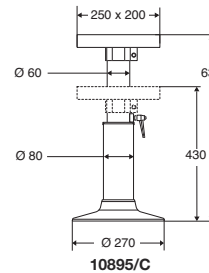

10895/C

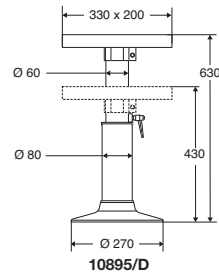

10895/D

10895/32	senza piastra né slitta / without plate or slide	Peso / Weight 3 Kg	cod. 08.40.13320
10895/A	con piastra universale / with universal plate	3,635 Kg	cod. 08.40.13001
10895/B	con piastra adatta alle nostre poltrone / with plate suitable for our chairs	3,660 Kg	cod. 08.40.13002
10895/C	con slitta universale / with universal slide	4,18 Kg	cod. 08.40.13003
10895/D	con slitta adatta alle nostre poltrone / with slide suitable for our chairs	5,12 Kg	cod. 08.40.13004

TELESCOPICO > MANUALE > MONOCOMANDO / TELESCOPIC > MANUAL > ONE HANDLE

supporto scomponibile con base a incasso / removable pedestal from inset lower base (00106)

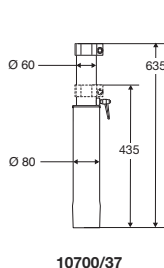

10700/37

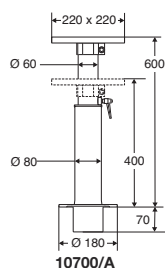

10700/A

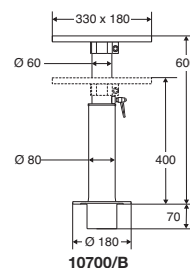

10700/B

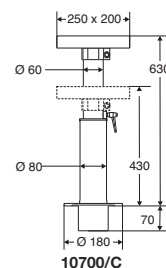

10700/C

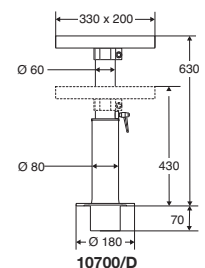

10700/D

10700/37	senza base, piastra né slitta / without base, plate or slide	Peso / Weight 1,7 Kg	cod. 08.40.12370
10700/A	con piastra universale / with universal plate	2,855 Kg	cod. 08.40.12001
10700/B	con piastra adatta alle nostre poltrone / with plate suitable for our chairs	2,880 Kg	cod. 08.40.12002
10700/C	con slitta universale / with universal slide	4,020 Kg	cod. 08.40.12003
10700/D	con slitta adatta alle nostre poltrone / with slide suitable for our chairs	4,320 Kg	cod. 08.40.12004

Tutte le misure sono espresse in mm / All measurements are in millimeters



SUPPORTI POLTRONA A GAS / GAS POWERED CHAIR PEDESTALS

TELESCOPICO > MANUALE > DOPPIOCOMANDO / TELESCOPIC > MANUAL > TWO HANDLE

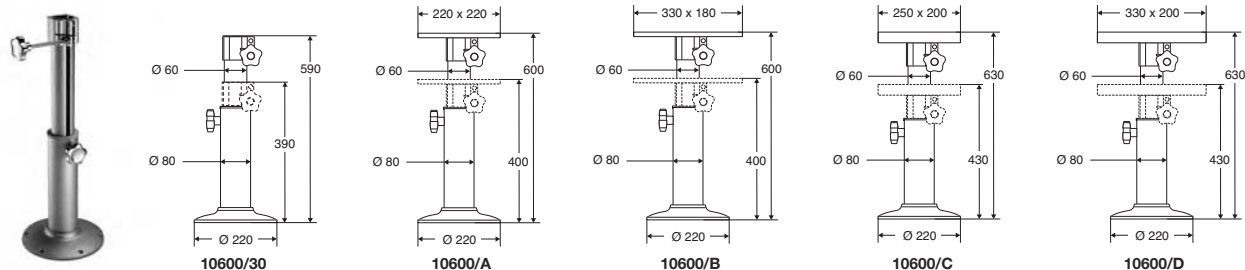

10600/30	senza piastra né slitta / without plate or slide	Peso / Weight 2,5 Kg	cod. 08.40.00300
10600/A	con piastra universale / with universal plate	3,135 Kg	cod. 08.40.00001
10600/B	con piastra adatta alle nostre poltrone / with plate suitable for our chairs	5,160 Kg	cod. 08.40.00002
10600/C	con slitta universale / with universal slide	4,3 Kg	cod. 08.40.00003
10600/D	con slitta adatta alle nostre poltrone / with slide suitable for our chairs	4,620 Kg	cod. 08.40.00004

TELESCOPICO > MANUALE > DOPPIOCOMANDO / TELESCOPIC > MANUAL > TWO HANDLE

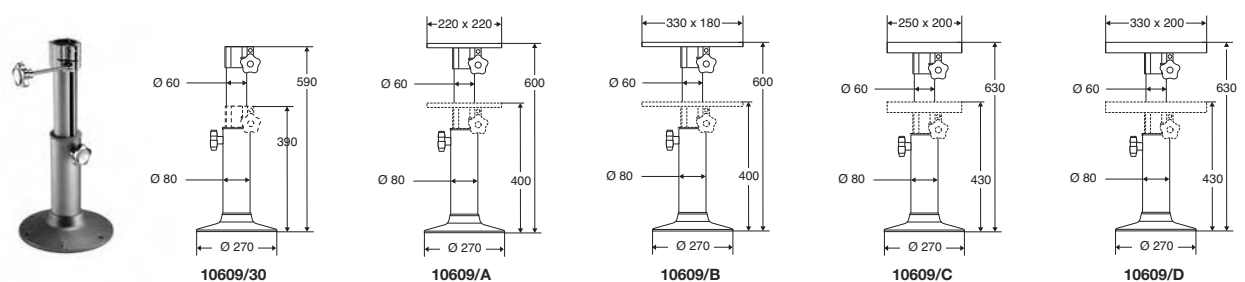

10609/30	senza piastra né slitta / without plate or slide	Peso / Weight 3,35 Kg	cod. 08.40.02300
10609/A	con piastra universale / with universal plate	3,985 Kg	cod. 08.40.02001
10609/B	con piastra adatta alle nostre poltrone / with plate suitable for our chairs	4,010 Kg	cod. 08.40.02002
10609/C	con slitta universale / with universal slide	5,150 Kg	cod. 08.40.02003
10609/D	con slitta adatta alle nostre poltrone / with slide suitable for our chairs	5,470 Kg	cod. 08.40.02004

TELESCOPICO > MANUALE > DOPPIOCOMANDO / TELESCOPIC > MANUAL > TWO HANDLE

asportabile / through floor

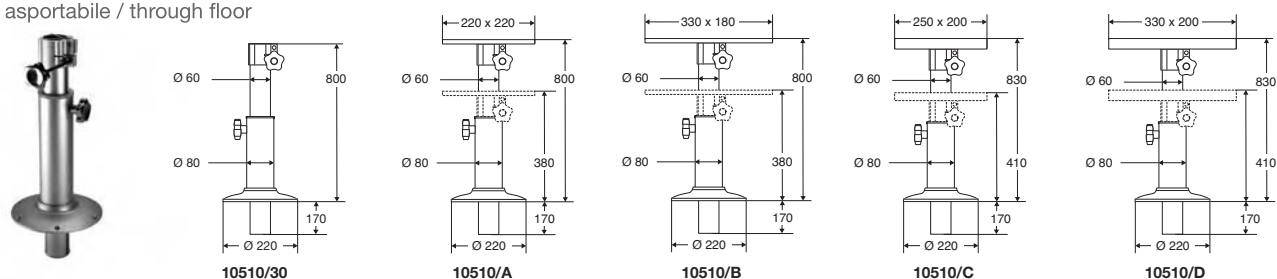

10510/30	senza piastra né slitta / without plate or slide	Peso / Weight 3,5 Kg	cod. 08.40.20300
10510/A	con piastra universale / with universal plate	4,135 Kg	cod. 08.40.20001
10510/B	con piastra adatta alle nostre poltrone / with plate suitable for our chairs	4,160 Kg	cod. 08.40.20002
10510/C	con slitta universale / with universal slide	5,3 Kg	cod. 08.40.20003
10510/D	con slitta adatta alle nostre poltrone / with slide suitable for our chairs	5,62 Kg	cod. 08.40.20004

Tutte le misure sono espresse in mm / All measurements are in millimeters



SUPPORTI POLTRONA A GAS / GAS POWERED CHAIR PEDESTALS

TELESCOPICO > MOLLEGGIATO / TELESCOPIC > SOFT RIDE

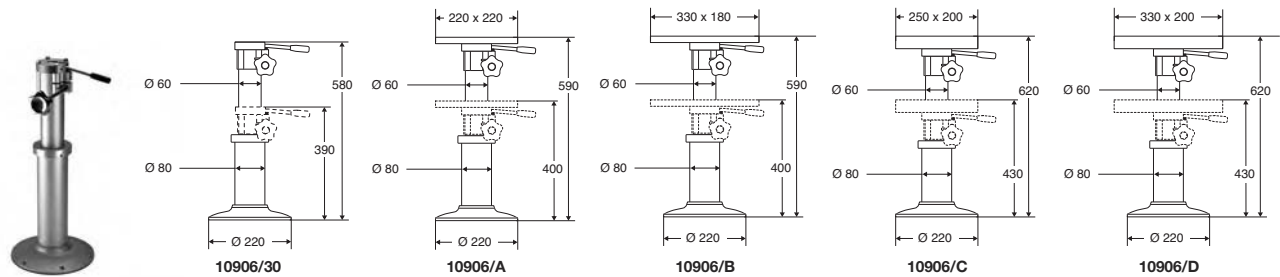

10906/30	senza piastra né slitta / without plate or slide	Peso / Weight 4,1 Kg	cod. 08.30.01300
10906/A	con piastra universale / with universal plate	4,735 Kg	cod. 08.30.01001
10906/B	con piastra adatta alle nostre poltrone / with plate suitable for our chairs	4,760 Kg	cod. 08.30.01002
10906/C	con slitta universale / with universal slide	5,9 Kg	cod. 08.30.01003
10906/D	con slitta adatta alle nostre poltrone / with slide suitable for our chairs	6,220 Kg	cod. 08.30.01004

TELESCOPICO > MOLLEGGIATO / TELESCOPIC > SOFT RIDE

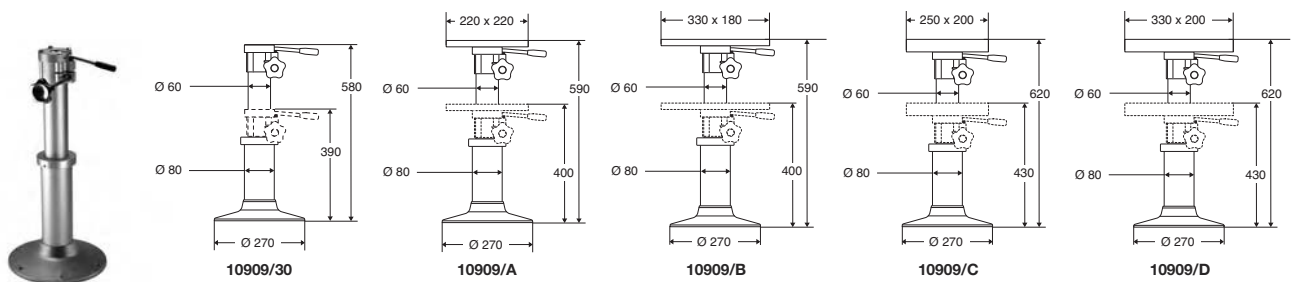

10909/30	senza piastra né slitta / without plate or slide	Peso / Weight 4,5 Kg	cod. 08.30.02300
10909/A	con piastra universale / with universal plate	5,135 Kg	cod. 08.30.02001
10909/B	con piastra adatta alle nostre poltrone / with plate suitable for our chairs	5,160 Kg	cod. 08.30.02002
10909/C	con slitta universale / with universal slide	6,3 Kg	cod. 08.30.02003
10909/D	con slitta adatta alle nostre poltrone / with slide suitable for our chairs	6,620 Kg	cod. 08.30.02004

ADATTE A POLTRONE PIÙ GRANDI E YACHT PIÙ VELOCI / SUITABLE FOR LARGER CHAIRS AND FASTER YACHTS

TESTA GIREVOLE / SWIVEL TOP



12508 Peso / Weight 7,9 Kg **cod. 08.30.12000**

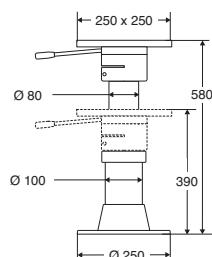

CON SPORGENZA E TESTA GIREVOLE
ADJUSTABLE LOWER BASE AND SWIVEL TOP



12508/R **cod. 08.30.13000**

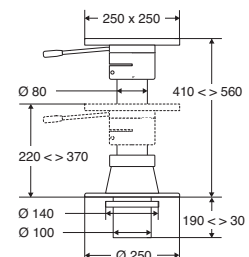

Tutte le misure sono espresse in mm / All measurements are in millimeters



SUPPORTI POLTRONA ALTEZZA FISSA / FIXED HEIGHT CHAIR PEDESTALS

GIREVOLE / SWIVEL TOP

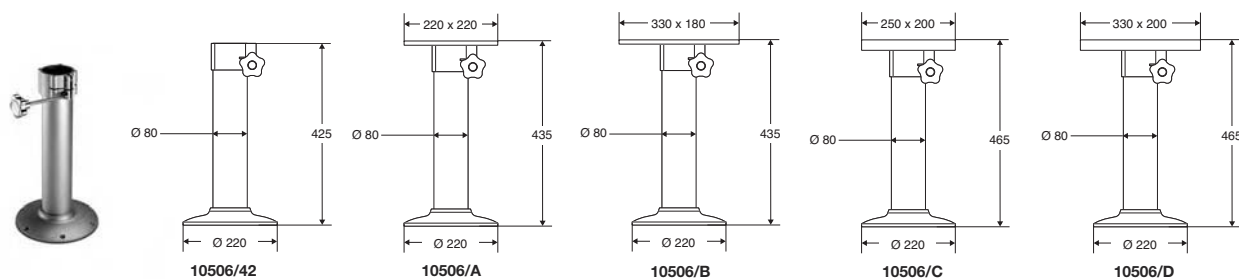

10506/42	senza piastra né slitta / without plate or slide	Peso / Weight 2,2 Kg	cod. 08.35.10420
10506/A	con piastra universale / with universal plate	2,835 Kg	cod. 08.35.10001
10506/B	con piastra adatta alle nostre poltrone / with plate suitable for our chairs	2,860 Kg	cod. 08.35.10002
10506/C	con slitta universale / with universal slide	4 Kg	cod. 08.35.10003
10506/D	con slitta adatta alle nostre poltrone / with slide suitable for our chairs	4,4 Kg	cod. 08.35.10004

GIREVOLE / SWIVEL TOP

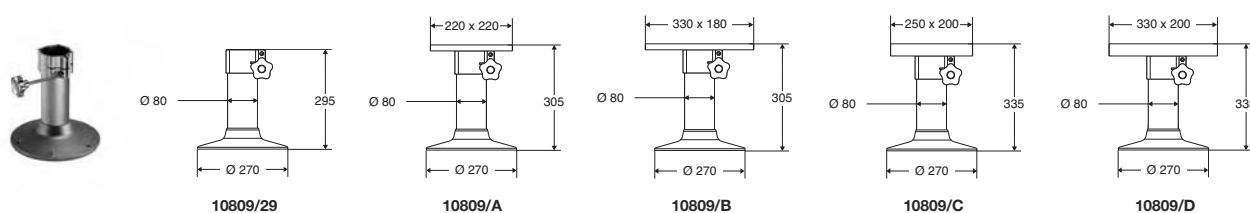

10809/29	senza piastra né slitta / without plate or slide	Peso / Weight 2,56 Kg	cod. 08.35.12290
10809/A	con piastra universale / with universal plate	3,195 Kg	cod. 08.35.12001
10809/B	con piastra adatta alle nostre poltrone / with plate suitable for our chairs	3,22 Kg	cod. 08.35.12002
10809/C	con slitta universale / with universal slide	4,36 Kg	cod. 08.35.12003
10809/D	con slitta adatta alle nostre poltrone / with slide suitable for our chairs	4,68 Kg	cod. 08.35.12004

GIREVOLE / SWIVEL TOP

supporto scomponibile con base a incasso / removable pedestal from inset lower base (00106)

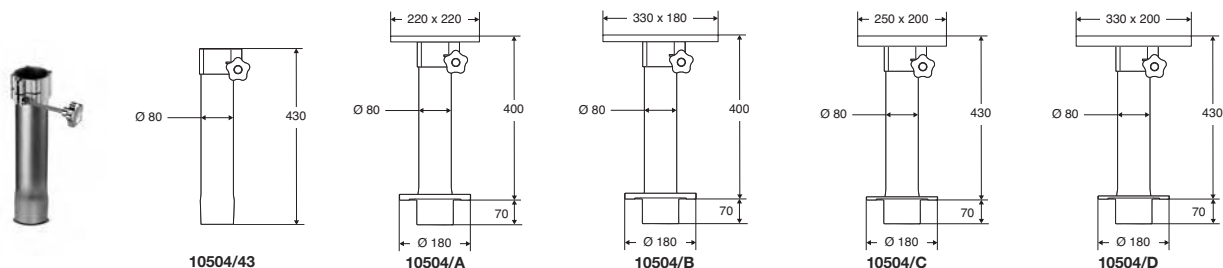

10504/43	senza base, piastra né slitta / without base, plate or slide	Peso / Weight 2,9 Kg	cod. 08.35.32430
10504/A	con piastra universale / with universal plate	4,055 Kg	cod. 08.35.32001
10504/B	con piastra adatta alle nostre poltrone / with plate suitable for our chairs	4,08 Kg	cod. 08.35.32002
10504/C	con slitta universale / with universal slide	5,22 Kg	cod. 08.35.32003
10504/D	con slitta adatta alle nostre poltrone / with slide suitable for our chairs	5,54 Kg	cod. 08.35.32004

Tutte le misure sono espresse in mm / All measurements are in millimeters

POLTRONE / CHAIRS

YACHTSMAN > 11000



Peso
Weight
3,1 Kg

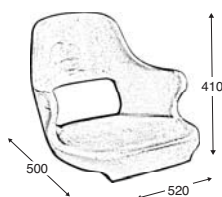

Colore bianco, materiale additivato con protettivo anti UV

White color, material improved with an anti UV additive

11000

cod. 07.01.00000

11010 coppia di cuscini / pair of cushion

cod. 07.11.00000

COMMODORE > 11001



Peso
Weight
3,5 Kg

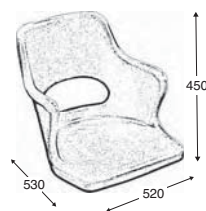

Colore bianco, materiale additivato con protettivo anti UV

White color, material improved with an anti UV additive

11001

cod. 07.01.10000

11010/1 coppia di cuscini / pair of cushion

cod. 07.11.00001



SEAFARER > 11002



Peso
Weight
2,8 Kg

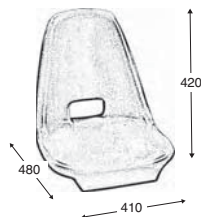

Colore bianco, materiale additivato con protettivo anti UV

White color, material improved with an anti UV additive

11002

cod. 07.01.20000

11010/2 coppia di cuscini / pair of cushion

cod. 07.11.00002

ADMIRAL > 11004



Peso
Weight
3,3 Kg

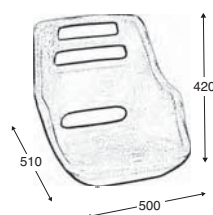

Colore bianco, materiale additivato con protettivo anti UV

White color, material improved with an anti UV additive

11004

cod. 07.01.40000

11010/4 coppia di cuscini / pair of cushion

cod. 07.11.00004

PROLUNGA SCORREVOLE PER TAVOLI A RIBALTA / SLIDE FOR FOLDING TABLES > 18801

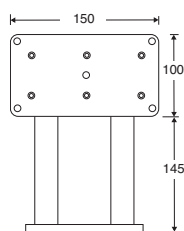

Sostegno scorrevole in lega leggera anodizzata, disponibile in diverse misure
Sliding support in anodized light alloy, available in different size

18801

cod. 08.92.00350

Tutte le misure sono espresse in mm / All measurements are in millimeters

PIASTRE E SLITTE / PLATES AND SLIDERS

PIASTRA UNIVERSALE DI FISSAGGIO / UNIVERSAL TOP PLATE FOR CHAIR PEDESTALS > 00100



Peso
Weight
635 g

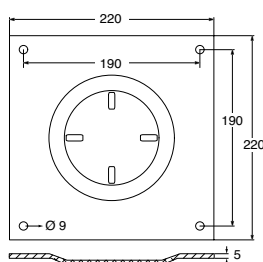

Costruita in lega leggera anodizzata
Anodized light alloy slider

00100

cod. 08.92.00000

PIASTRA PER LE NOSTRE POLTRONE / TOP PLATE SUITABLE FOR OUR CHAIRS > 00101



Peso
Weight
660 g

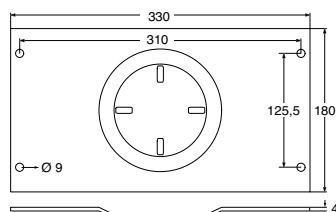

Costruita in lega leggera anodizzata
Anodized light alloy slider

00101

cod. 08.92.00100

SLITTA UNIVERSALE PER POLTRONE / UNIVERSAL SLIDE FOR CHAIR PEDESTALS > 10900



Peso
Weight
1,8 Kg

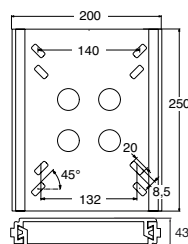

Costruita in lega leggera anodizzata
Corsa 190 mm
Anodized light alloy slider
Stroke 190 mm

10900

cod. 08.92.00200

SLITTA PER LE NOSTRE POLTRONE / SLIDE FOR OUR CHAIRS > 10901



Peso
Weight
2,12 Kg

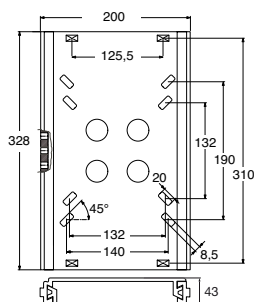

Costruita in lega leggera anodizzata
Corsa 135 mm
Anodized light alloy slider
Stroke 135 mm

10901

cod. 08.92.00300

SLITTA PER TAVOLI / SLIDE FOR TABLES > 10903



Peso
Weight
2,35 Kg

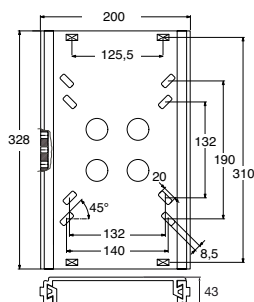

Costruita in lega leggera anodizzata
Corsa 270 mm
Anodized light alloy slider
Stroke 270 mm

10903

cod. 08.92.00305

Tutte le misure sono espresse in mm / All measurements are in millimeters

BASI / BASES

BASE PER SUPPORTI ASPORTABILI / BASE FOR REMOVABLE PEDESTALS > 00102



Peso
Weight
390 g

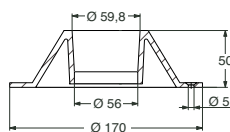

Costruita in alluminio sabbato,
anodizzato e brillantato

Made in sand blast,
anodized and shined light alloy

00102

cod. 08.90.00102

BASE AD INCASSO PER SUPPORTI ASPORTABILI / EMBEDDED BASE FOR REMOVABLE PEDESTAL > 00103



Peso
Weight
410 g

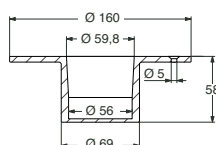

Costruita in alluminio
lucidato e anodizzato

Made in polished
and anodized light alloy

00103

cod. 08.90.00103

BASE AD INCASSO PER SUPPORTI ASPORTABILI / EMBEDDED BASE FOR REMOVABLE PEDESTAL > 00106



Peso
Weight
520 g

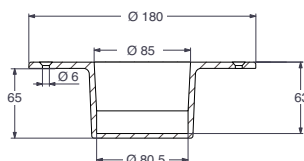

Costruita in alluminio sabbato,
anodizzato e brillantato

Made in sand blast,
anodized and shined light alloy

00106

cod. 08.90.00106

BASE AD INCASSO PER SUPPORTI ASPORTABILI / EMBEDDED BASE FOR REMOVABLE PEDESTAL > 00106/1



Peso
Weight
590 g

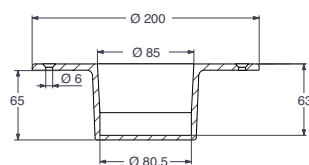

Costruita in alluminio
lucidato e anodizzato

Made in polished
and anodized light alloy

00106/1

cod. 08.90.00116

BASE AD INCASSO PER SUPPORTI ASPORTABILI / EMBEDDED BASE FOR REMOVABLE PEDESTAL > 00107



Peso
Weight
725 g

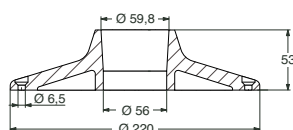

Costruita in alluminio sabbato,
anodizzato e brillantato

Made in sand blast,
anodized and shined light alloy

00107

cod. 08.90.00107

Tutte le misure sono espresse in mm / All measurements are in millimeters

BASE PER SUPPORTI ASPORTABILI / BASE FOR REMOVABLE PEDESTALS > 00109



Peso
Weight
1,26 Kg

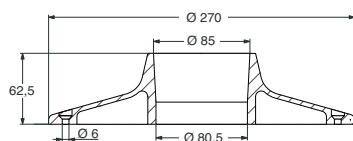

Costruita in alluminio sabbato,
anodizzato e brillantato

Made in sand blast,
anodized and shined light alloy

00109

cod. 08.90.00109

COPRIFORO PER BASE AD INCASSO / COVER FOR INSET BASES > 00222



Copriforo in plastica
per base 00103
utilizzata nel supporto 10191

Plastic lid
for 00103 base
used with the 10191 pedestal

00222

cod. 08.90.00222

COPRIFORO PER BASE AD INCASSO / COVER FOR INSET BASES > 00292

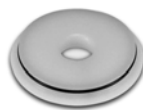

Copriforo in plastica
per basi 00106 e 00106/1
utilizzate nei supporti
10193 - 10293 - 10295 - 10504 - 10700

Plastic lid
for bases 00106 and 00106/1
used with the
10193 - 10293 - 10295 - 10504 - 10700 pedestals

00292

cod. 08.90.00292



Tutte le misure sono espresse in mm / All measurements are in millimeters

ACCESSORI E RICAMBI / SPARE PARTS & ACCESSORIES

CENTRALINA ELETTRONICA / CONTROL BOX > 01053/XXX/XX

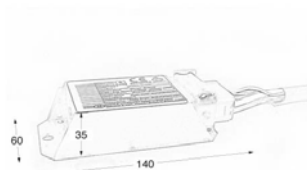

Peso
Weight
360 g

Per supporti elettrici senza encoder
Costruita in plastica
con circuiti immersi in resina ignifuga
Indicare la TIPOLOGIA DEL SUPPORTO
(poltrona o tavolo, uno o due stadi)
e i relativi voltaggi

For electric pedestals without encoder
Built in plastic with the
electronics sealed in a self-extinguishing resin
Indicate the SERIAL NUMBER
of the item or the characteristic
(chair or table, one or two stage)
voltage and amperage

ARTICOLO / ITEM		VOLT	AMPERE	CODICE / CODE
01053/15A/12	per supporti tavolo, poltrona e attuatori for table pedestals, chairs pedestals and struts	12	15	09.99.00017
01053/7,5A/24		24	7,5	09.99.00018
01053/12A/12		12	12	09.99.00015
01053/6A/24		24	6	09.99.00016
01053/10A/12		12	10	09.99.00011
01053/5A/24		24	5	09.99.00012
01053/8A/12		12	8	09.99.00013
01053/4A/24		24	4	09.99.00014
01053/100/12		12	7	09.99.00009
01053/100/24		24	3,5	09.99.00010
01053/150/12		12	6	09.99.00001
01053/150/24		24	3	09.99.00002
01053/200/12		12	8	09.99.00003
01053/200/24		24	4	09.99.00004

CENTRALINA ELETTRONICA / CONTROL BOX > E 01134/XX

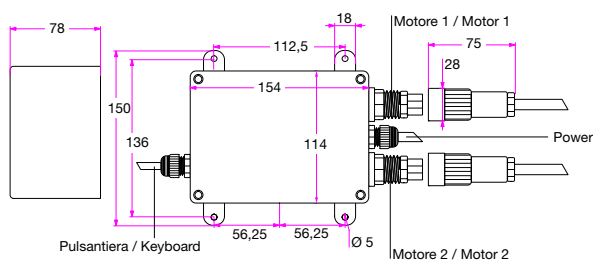

Peso
Weight
890 g

Per impianti in coppia / For double units

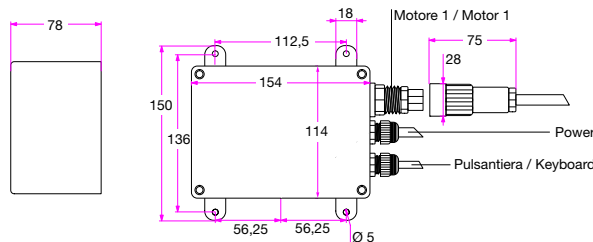

Per impianti singoli / For single units

Per IMPIANTI
CON ENCODER e
sincronizzati
Indicare la tipologia
del supporto
(singolo o coppia,
poltrona o tavolo,
uno o due stadi)
e i relativi voltaggi

For synchronized
UNITS WITH ENCODER
Indicate the
SERIAL NUMBER
of the item or
the characteristic
(single or pair,
chair or table,
one or two stage)
voltage and amperage

Tutte le misure sono espresse in mm / All measurements are in millimeters

TELESCOPICO A UNO STADIO / KEYBOARD > E01135



Tastiera di regolazione e comando per impianti con encoder
Costruzione in plastica con circuiti immersi in resina idrofuga

Set-up and operating keyboard for units with encoder
Made in plastic with circuits immersed in a waterproof resin

E01135

cod. 09.99.00056

TELESCOPICO A UNO STADIO / THROUGH BULKHEAD GLAND > E01160



Passa paratia opzionale per i nostri cavi con connettore
Corpo in polipropilene nero

Through bulkhead gland for BARKA's cables with plug (optional)
Body in black polypropylene

E01160

cod. 09.99.00057

CAVO DI PROLUNGA / EXTENSION > 01167



Cavi di prolunga per impianti con encoder (opzionali)
Indispensabili quando la lunghezza dei cavi standard (1,30 m) non consente di raggiungere la centralina di controllo

Extension cables for units with encoder (optional)
Indispensables when the length of the standard cables (1,30 m) is insufficient to reach the control box

01167 2 metri / meters Peso/Weight 260 g

cod. 09.99.00054

01168 5 metri / meters Peso/Weight 520 g

cod. 09.99.00055

01180 8 metri / meters Peso/Weight 755 g

cod. 09.99.00059

TELESCOPICO A UNO STADIO / REMOTE CONTROL > RXTX2RC



Kit telecomando con ricevitore
Consente di comandare da remoto il movimento degli attuatori e dei supporti tavolo

Complete remote control unit
It allows to drive the movement of the struts and table pedestals from remote

RXTX2RC kit telecomando + ricevitore / kit remote control + receiver

cod. 09.99.00061

TX2RC telecomando aggiuntivo / additional remote control

cod. 09.99.00062

Tutte le misure sono espresse in mm / All measurements are in millimeters

ACCESSORI E RICAMBI / SPARE PARTS & ACCESSORIES

AVVISATORE DI MOVIMENTO / MOVEMENT ALARM > BEBIP

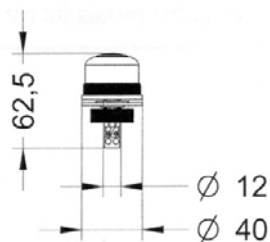

Avvisatore acustico di movimento, 12 o 24 Volt
Grado di protezione da polvere ed acqua: IP55

Buzzer, 12 or 24 Volt
Degree of protection from dust and water: IP55

BEBIP/12

cod. 09.99.00051

BEBIP/24

cod. 09.99.00052

GUARNIZIONE TATTILE / SAFETY TACTILE SEAL > W18000

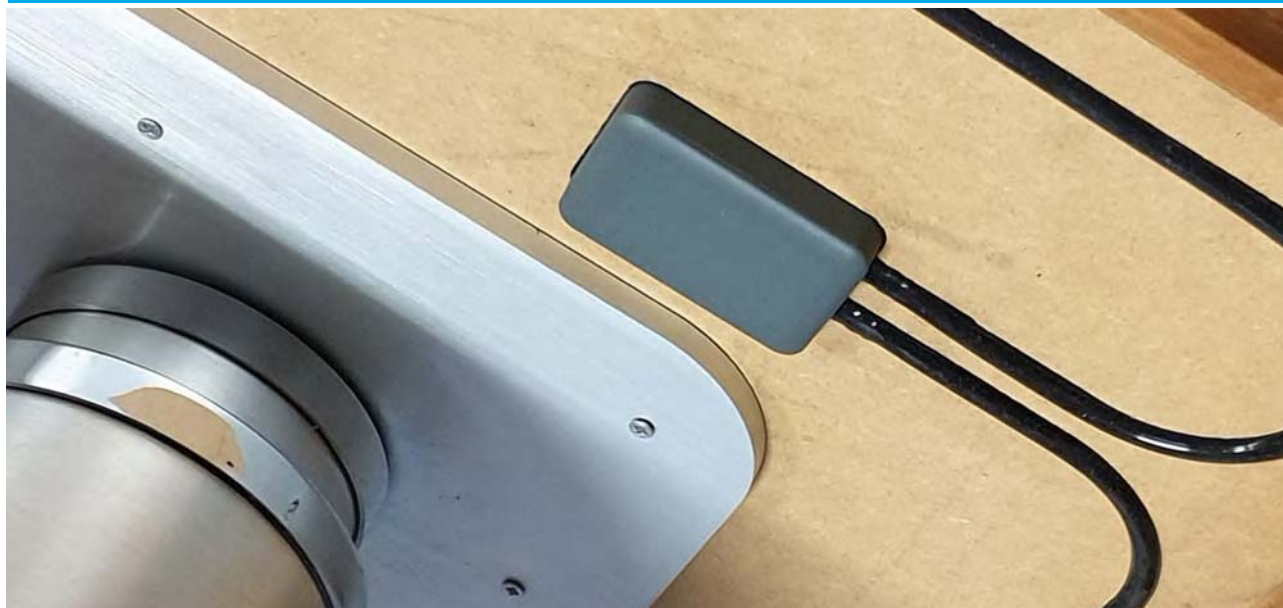

Kit di sicurezza – Completo di elettronica (TX RX Wi-fi) e guarnizione tattile
Security kit – Complete of WiFi electronics (TX x RX) and pressure sensor

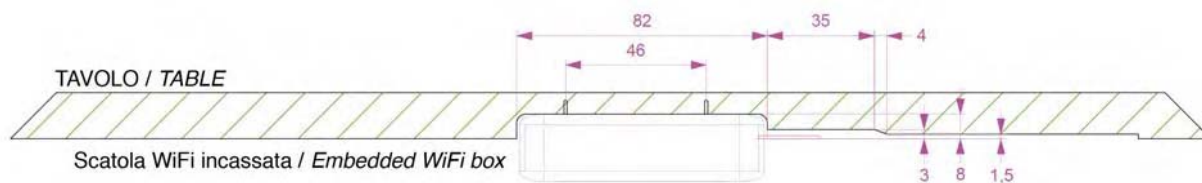
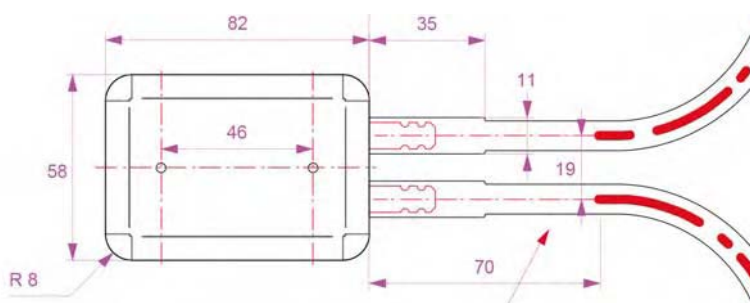

W18000	5 metri / meters	Peso/Weight 280 g	cod. 09.99.00070
W18001	8 metri / meters	Peso/Weight 483 g	cod. 09.99.00071
W18002	10 metri / meters	Peso/Weight 687 g	cod.09.99.00072

Tutte le misure sono espresse in mm / All measurements are in millimeters



VERSIONI DA INTERNO / INDOOR VERSIONS

Gli alza televisori **barka**, telescopici a doppio stadio, si caratterizzano per il minimo ingombro, la flessibilità d'installazione e la facilità di regolazione della traslazione. L'ingombro verticale di ogni modello, in posizione rientrata è inferiore alla corsa disponibile: dove trova spazio il televisore ci sta anche l'alza tv. Vengono prodotti con corse di 500, 650 e 800 mm, per fissaggio a pavimento o a paratia. La staffa di fissaggio del televisore consente di alzare ulteriormente la posizione fino a 36 cm. I punti di minima e massima altezza possono essere regolati elettronicamente a seconda delle necessità. Tutte le versioni accettano gli standard VESA di fissaggio del televisore da 100x100, 200x200, 300x200, 300x300, 400x300 e 400x400 mm. Disponibile a richiesta un telecomando.

The **barka** two stages telescopic TV lift are incredibly compact, have an outstanding mounting flexibility and ease of set-up of the translation. When shortened, the vertical height of each model is less than its stroke: where you can fit the screen you can install the TV lift. Available with a stroke of 500 - 650 and 800 mm and with the choice of floor or bulkhead mounting. The TV mounting bracket can be lifted up to 36 cm over the minimum. The starting and ending points can be modified electronically to fit the individual requirements. All the versions are suitable for the VESA fixing points 100x100 - 200x200 - 300x200 - 300x300 - 400x300 - 400x400 mm. A remote control can be supplied as an optional.



CORSA / STROKE > 800 mm

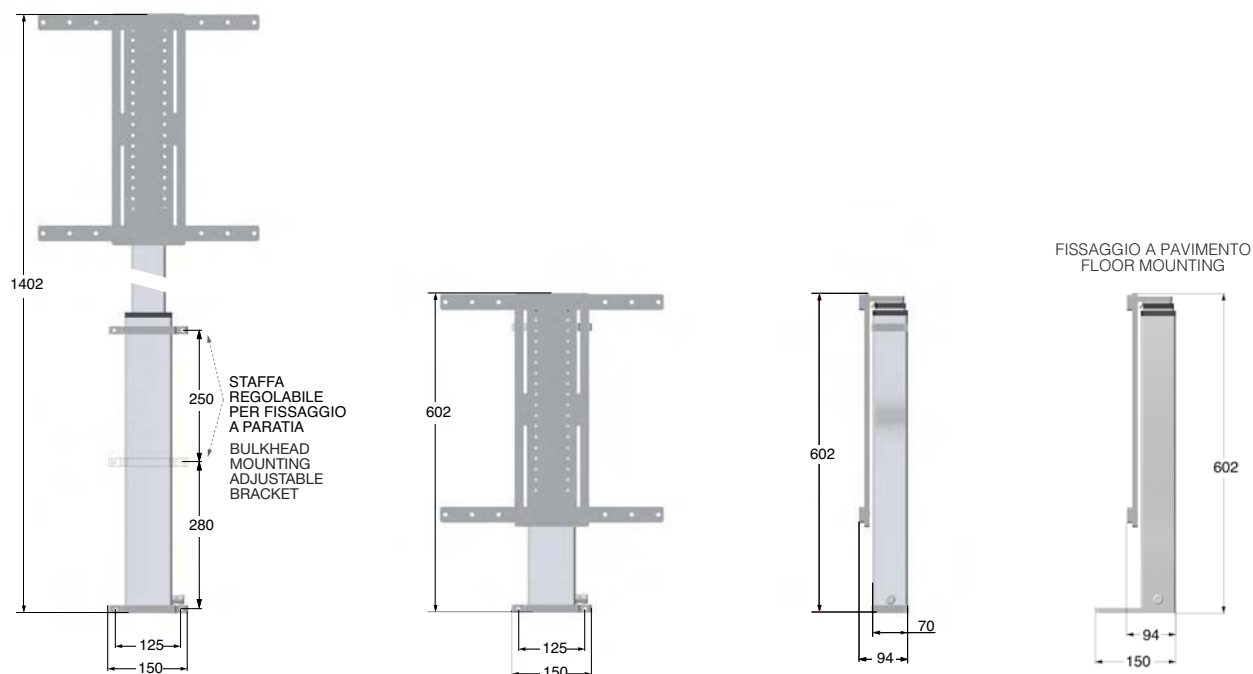

E170003/12	fissaggio a pavimento / floor mounting	cod. 09.97.10005
E170003/24	fissaggio a pavimento / floor mounting	cod. 09.97.10006
E170006/12	fissaggio a paratia / bulkhead mounting	cod. 09.97.11005
E170006/24	fissaggio a paratia / bulkhead mounting	cod. 09.97.11006

Tutte le misure sono espresse in mm / All measurements are in millimeters

CORSA / STROKE > 650 mm

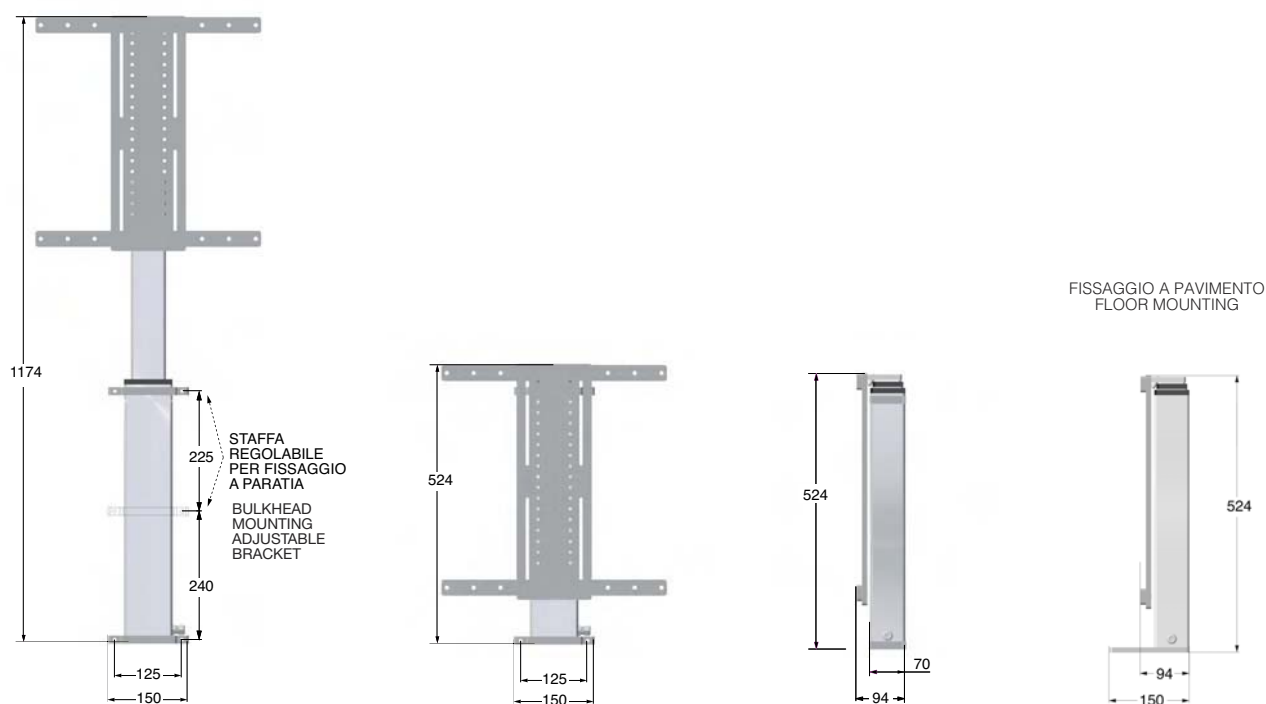

E170002/12	fissaggio a pavimento / floor mounting	cod. 09.97.10003
E170002/24	fissaggio a pavimento / floor mounting	cod. 09.97.10004
E170005/12	fissaggio a paratia / bulkhead mounting	cod. 09.97.11003
E170005/24	fissaggio a paratia / bulkhead mounting	cod. 09.97.11004

CORSA / STROKE > 500 mm

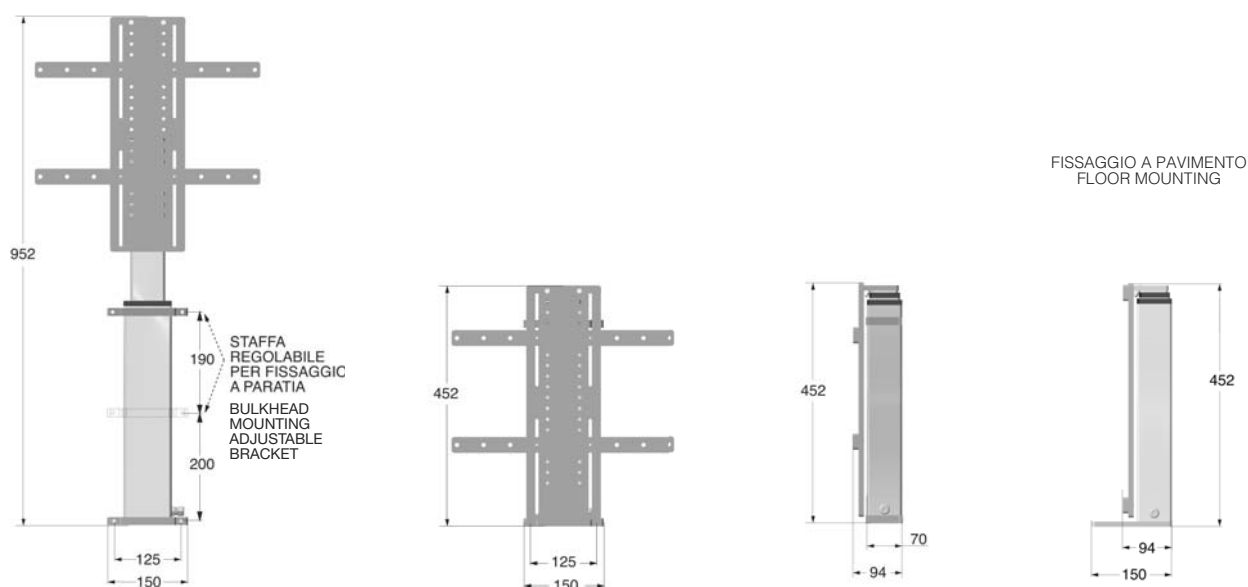

E170001/12	fissaggio a pavimento / floor mounting	cod. 09.97.10001
E170001/24	fissaggio a pavimento / floor mounting	cod. 09.97.10002
E170004/12	fissaggio a paratia / bulkhead mounting	cod. 09.97.11001
E170004/24	fissaggio a paratia / bulkhead mounting	cod. 09.97.11002

Tutte le misure sono espresse in mm / All measurements are in millimeters

VERSIONI DA ESTERNO / OUTDOOR VERSIONS

MOTORE IN LINEA / IN-LINE MOTOR

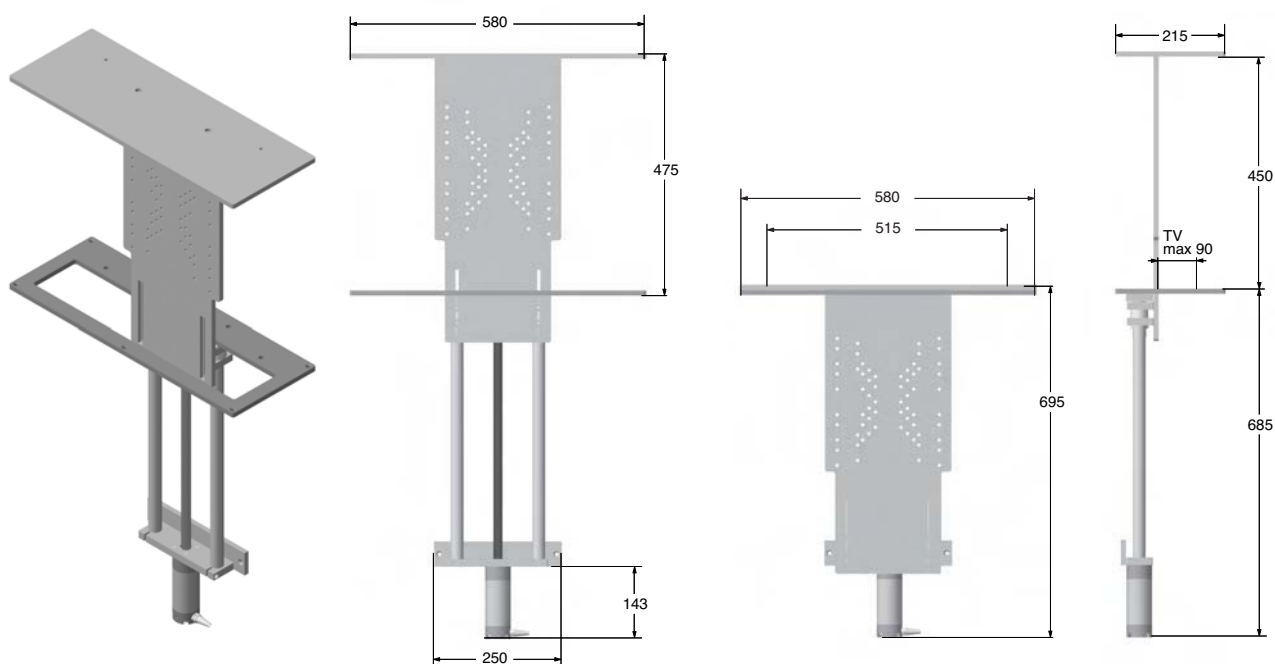

184508/12

cod. 09.97.00301

184508/24

cod. 09.97.00302

E184508/12

encoder

cod. 09.97.01301

E184508/24

encoder

cod. 09.97.01302

MOTORE LATERALE / SIDE MOTOR

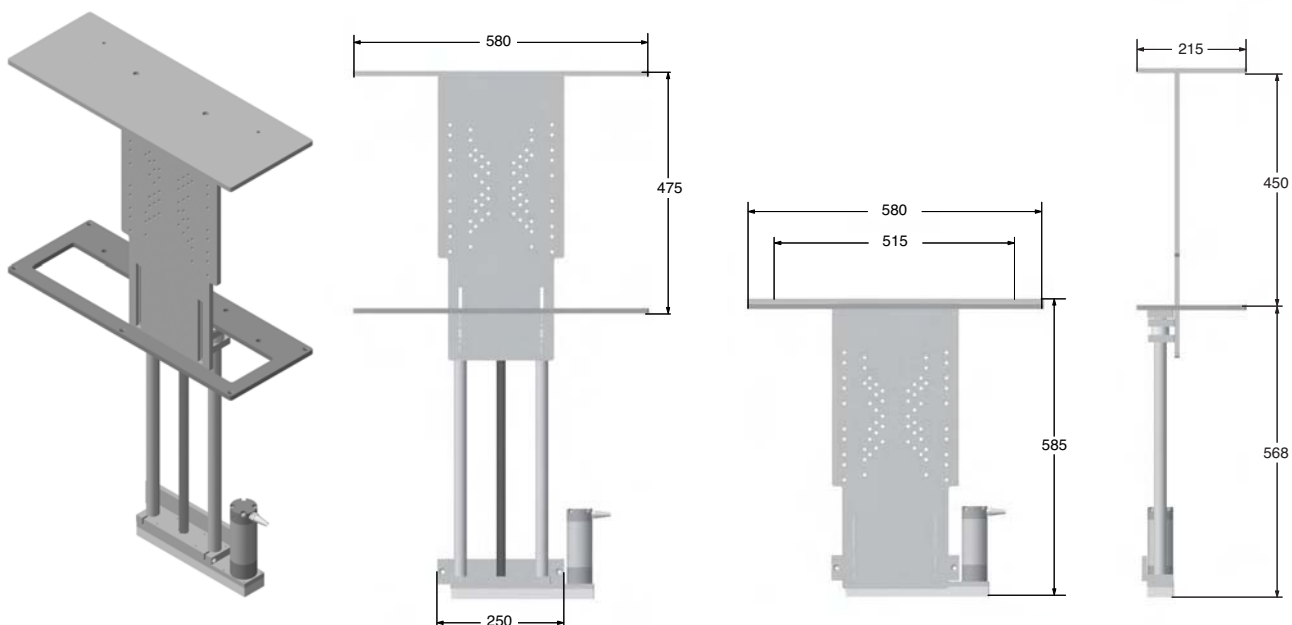

184509/12

cod. 09.97.00401

184509/24

cod. 09.97.00402

E184509/12

encoder

cod. 09.97.01401

E184509/24

encoder

cod. 09.97.01402

Tutte le misure sono espresse in mm / All measurements are in millimeters



Strada Padana Superiore, 256/266
20090 Vimodrone - MI (Italy)
Tel: +39.02.27.40.80.33
Fax: +39.02.25.04.072
info@barka.it
www.barka.it